



**Agenda Item A.1**  
**CONSENT CALENDAR**  
**Meeting Date: July 1, 2008**

---

**TO:** Mayor and Councilmembers

**FROM:** Daniel Singer, City Manager

**CONTACT:** Marti Schultz, Principal Civil Engineer

**SUBJECT:** Construction Contract for the FY 2008-2009 Pavement Rehabilitation Project, Phase 2 – Slurry Seal

**RECOMMENDATION:**

- A. Authorize the City Manager to execute a construction contract for Phase 2 of the FY 2008-2009 Pavement Rehabilitation Project, Slurry Seal to Bond Blacktop, Inc., in the amount of \$923,125 subject to the requirements of the contract documents; and
- B. Authorize the City Manager to approve contract change orders as necessary for Phase 2 of the FY 2008-2009 Pavement Rehabilitation Project, Slurry Seal in an amount not to exceed \$180,000.

**BACKGROUND:**

On December 3, 2007, City Council authorized the execution of a professional services agreement with Flowers and Associates, Inc. (Flowers) for the design of the FY 2008-2009 Pavement Rehabilitation Project. The Pavement Rehabilitation Project is divided into two phases: Phase 1 - Pavement Preparation, and Phase 2 – Slurry Seal. This Council agenda item is for the award of Phase 2 – Slurry Seal.

The list of streets included in the Slurry Seal Project (Attachment 1), and vicinity maps (Attachment 2) showing the areas of work are attached to this report.

**DISCUSSION:**

Bids for the Slurry Seal Project were opened on May 21, 2008. A total of four (4) bids were received. The engineer's estimate for the project was \$1,300,000. The lowest bid submitted was from Bond Blacktop, Inc., in the amount of \$923,125.

A summary of the bids received is shown in the table below and a copy of the detailed bid results is attached to this report (Attachment 3).

<b>Contractor</b>	<b>Office Location</b>	<b>Bid Amount</b>
Bond Blacktop, Inc.	Union City	\$923,125.00
Valley Slurry Seal	W. Sacramento	\$1,153,029.00
Pavement Coatings Co.	Cypress	\$1,259,662.50
Roy Allan Slurry Seal, Inc.	Santa Fe Springs	\$1,405,300.00

Bond Blacktop is a qualified firm that specializes in slurry seals. Bond Blacktop has performed similar slurry seal projects for other municipalities on time and within budget, one of the most recent projects being for the City of Camarillo. Based on the bids submitted and the previous experience, staff recommends award of the slurry seal contract to Bond Blacktop, Inc.

### Professional Services Agreement

The total estimated cost for construction of the Pavement Rehabilitation projects is \$1.7 million. On June 3, 2008, the City Council awarded a professional services agreement to Flowers & Associates, Inc. (Flowers) to provide construction management, inspection and testing (CMI&T) services an amount not to exceed \$216,961 for both the Pavement Preparation and Slurry Seal projects. The CMI&T services is approximately 13% of the estimated construction cost which is in line with the industry standard for these types of projects.

### **ALTERNATIVES:**

The Council may reject the bids for the Slurry Seal project and direct staff to rebid the projects. However, doing so would result in a delay in the proposed street improvement program and an increase to the overall project costs.

### **FISCAL IMPACTS:**

The amended FY 2008-2009 Budget includes approximately \$2.0 million pavement rehabilitation as part of the City's Street Improvement and Reinvestment Program. Since the bids came in lower than estimated, staff is recommending a 20% change order authority for the Slurry Seal contract. This change order authority amount will allow for more streets to be rehabilitated this Fiscal Year. The additional change order authority will not exceed the proposed budget for the Fiscal Year 2008-2009 Pavement Rehabilitation Project as shown in the table below:

PAVEMENT REHABILITATION PROJECT, FY 2008-2009					
	Design FY 09-10	Construction FY 08-09	Change Order FY 08-09	CM, I & T** FY 08-09	TOTAL
Phase 1 – Pavement Prep.		\$500,524	\$100,000	\$ 72,320	\$ 672,844
Phase 2 – Slurry Seal		\$923,125	\$180,000	\$144,641	\$1,247,766
Phase 3 – Asphalt Overlay	\$70,000*				\$ 70,000
<b>TOTAL:</b>	<b>\$70,000</b>	<b>\$1,423,649</b>	<b>\$280,000</b>	<b>\$216,961</b>	<b>\$1,990,610</b>

\*Estimated costs to be finalized at award of contract for the Design Services

\*\*Construction Management, Inspection & Testing

Funding for the project is included in the approved FY 2008-2009 Budget as shown in the following table:

PHASE 2 – SLURRY SEAL				
Fund and Acct. Number	Construction Contract	Change Order	Inspection	Totals
Measure D 205-5-5800-413	\$237,098			\$237,098
Gas Tax 201-5-5800-413	\$428,609			\$428,609
Gas Tax 201-5-5800-400	\$ 28,968		\$144,641	\$173,609
RSTP 305-5-5800-400	\$105,000			\$105,000
LSTP 306-5-5800-400	\$118,000			\$118,000
General Fund 101-5-5800-413	\$ 5,450	\$180,000		\$185,450
Total	\$923,125	\$180,000	\$144,641	\$1,247,766

Award of the construction contract to Bond Blacktop, Inc. for the Phase 2 – Slurry Seal as recommended will result in the improvement of approximately 24.6 lane miles on 44 separate street sections in the City.

Submitted By:

Reviewed By:

Approved By:

---

Steve Wagner  
Community Services  
Director

---

Michelle Greene  
Administrative Services  
Director

---

Daniel Singer  
City Manager

**ATTACHMENTS:**

1. List of streets to be included in Slurry Seal Project
2. Vicinity Maps
3. Slurry Seal Project Bid Summary

**ATTACHMENT 1**

**List of Streets**

FY 2008-2009 Pavement Rehabilitation Project, Phase 2 – Slurry Seal  
List of Streets

Street Name	From	To
Aberdeen	E/S Kamala Avenue	W/S Valdez Avenue
Alpine Drive	N/S Tuolumne Drive	CDS
Armitos Avenue	Dearborn Drive	End
Avenida Garza	S/S Covington Way	N/S Avenida Ganso
Barrington Way	E/S Carlo Drive	W/S Amherst Drive
Berkley	E/S Fairview Avenue	End
Calle Real	Daffodil Drive	W/S Brandon Drive
Calle Real	La Patera	W/S Fairview Avenue
Carlo Drive	S/S Stow Canyon Road	N/S Calle Real
Carmel Beach Circle	W/S Santa Barbara Shores	CDS
Castillian Drive	W/S Los Carneros Way	420' W/O Los Carneros Wy
Cathedral Oaks Bike Path	Glenn Annie	King Daniel
Cathedral Oaks Road	Calle Real	E/S Los Carneros
Coloma Drive	E/S Carlo Drive	W/S Vega Drive
Coromar Drive	N/S Hollister Avenue	270' N/O Hollister Avenue
Craigmont Drive	E/S Carlo Drive	East End
Cremona Drive	S/S Los Carneros Road	N/S Hollister Avenue
Dearborn Place	N/S Hollister Avenue	CDS
Del Norte Drive	180 W/O Glen Annie Road	W/S Glen Annie Road
Ellwood Beach Drive	E/S Entrance Drive	500' S/O/ Entrance Drive
Evergreen Drive	E/S Brandon Drive	Cathedral Oaks
Evergreen Drive	W/S Brandon Drive	West End
Fairview Avenue	S/S 101 Bridge Deck	N/S Hollister Avenue
Forest Drive	N/S Evergreen Drive	W/S Evergreen Drive
Glenn Annie Road	N/S Calle Real	Cathedral Oaks
Guava Avenue	E/S Kamala Way	W/S Valdez Avenue
Hollister Avenue	Dearborn Place	W/S Ward Drive
Hollister Avenue	Pebble Beach Drive	S/S 101 Bridge Deck
Kellogg Avenue	S/S Hollister Avenue	South Street
Kellogg Place	E/S Kellogg Way	W/S Kellogg Avenue
Kellogg Way	N/S Kellogg Avenue	North End
Linfield Place	N/S Whittier Drive	CDS
Murfield Drive	E/S Windsor Avenue	W/S Valdez Avenue
Pacific Oaks Road	S/S Hollister Avenue	N/S Marymount
Pismo Beach Cir.	W/S Santa Barbara Shores	CDS
Ravenscroft	N/S Pedernal Avenue	N/S Pedernal Avenue
Redwood Way	N/S Evergreen Drive	CDS
Rochester Place	W/S Calle Real	CDS
Rutherford	Hollister Avenue	S/S Dawson Street
Salisbury Avenue	N/S Evergreen Drive	CDS
San Mateo Avenue	S/S Madera Drive	N/S Calle Real
San Napoli Drive	Evergreen	CDS
San Napoli Drive	S/S Evergreen Drive	W/S Salisbury Avenue
Saratoga Ct	W/S Coronado	W/S Coronado
Seagull Drive	E/S Daytona	East End
Stow Canyon Road	E/S Fairview Avenue	Via Fiori
Strehle Lane	E/S Mathilda	W/S Ellwood Beach Drive
Verdura Avenue	E/S Carlo	W/S Vega Drive
Via Fiori	East CDS	West CDS
Ward Drive	3510' S/O Hollister Avenue	South End
Yolo Ln	Alpine	CDS

**ATTACHMENT 2**

**Vicinity Maps**

Z:\ACADDWG\0766-Slurry-Seal-Maps.dwg, SS-OverallSite, 4/16/2008 1:47:05 PM, ssorta, KONICA C450 PCL Copier.pc3, 11x17, 1:1

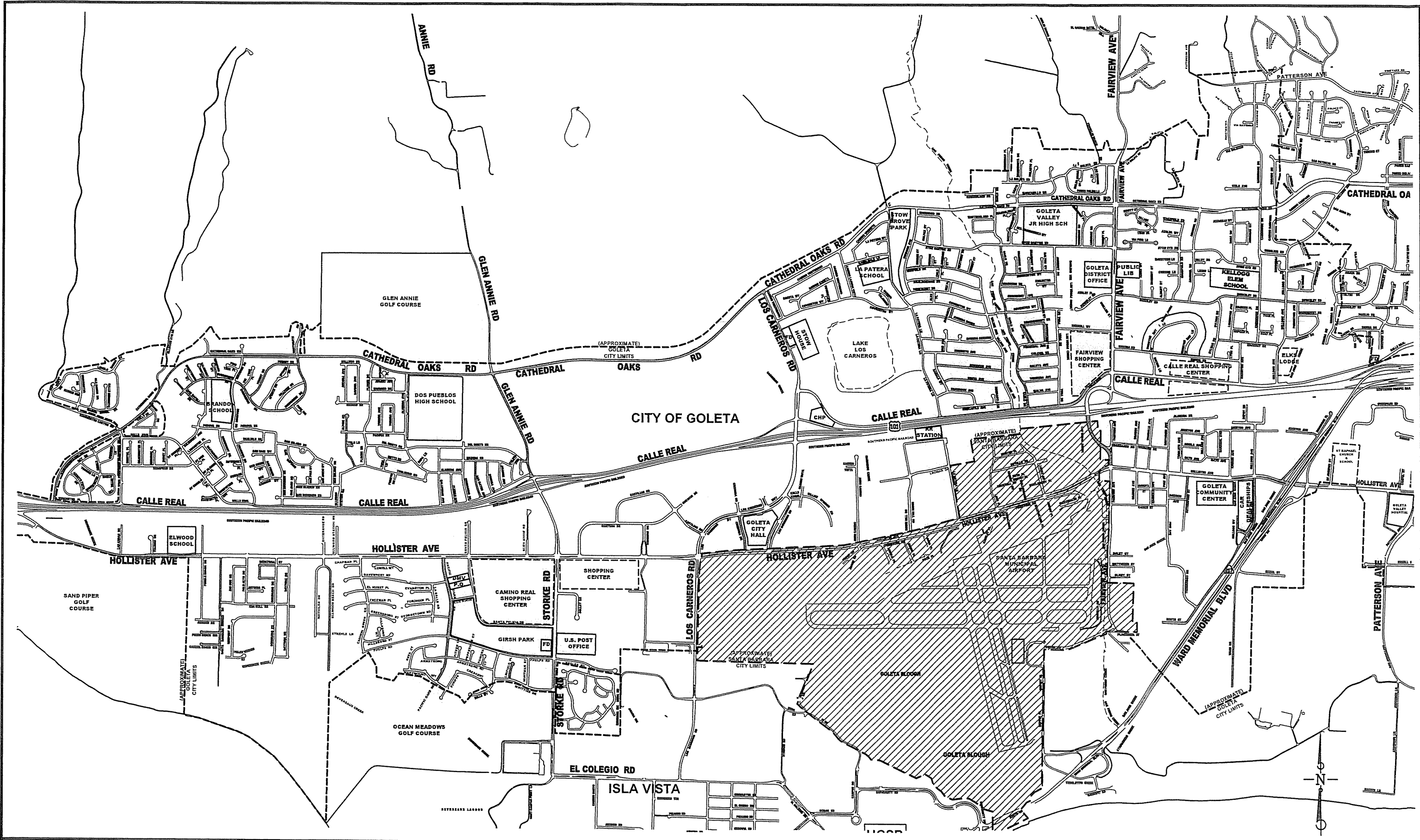

OVERALL VICINITY MAP

**FLOWERS & ASSOCIATES, INC.**

CIVIL ENGINEERS

201 North Calle Cesar Chavez, Suite 100 Santa Barbara, California 93103  
Telephone (805) 966-2224



CITY OF GOLETA  
2008/2009  
SLURRY SEAL  
PROJECT

W.O. 0766



Z:\ACADDWG\07666\Slurry-Seal-Maps.dwg, SS-1, 4/16/2008 1:47:11 PM, ssofia, KONICA C450 PCL Copier.pc3, 11x17, 1:1

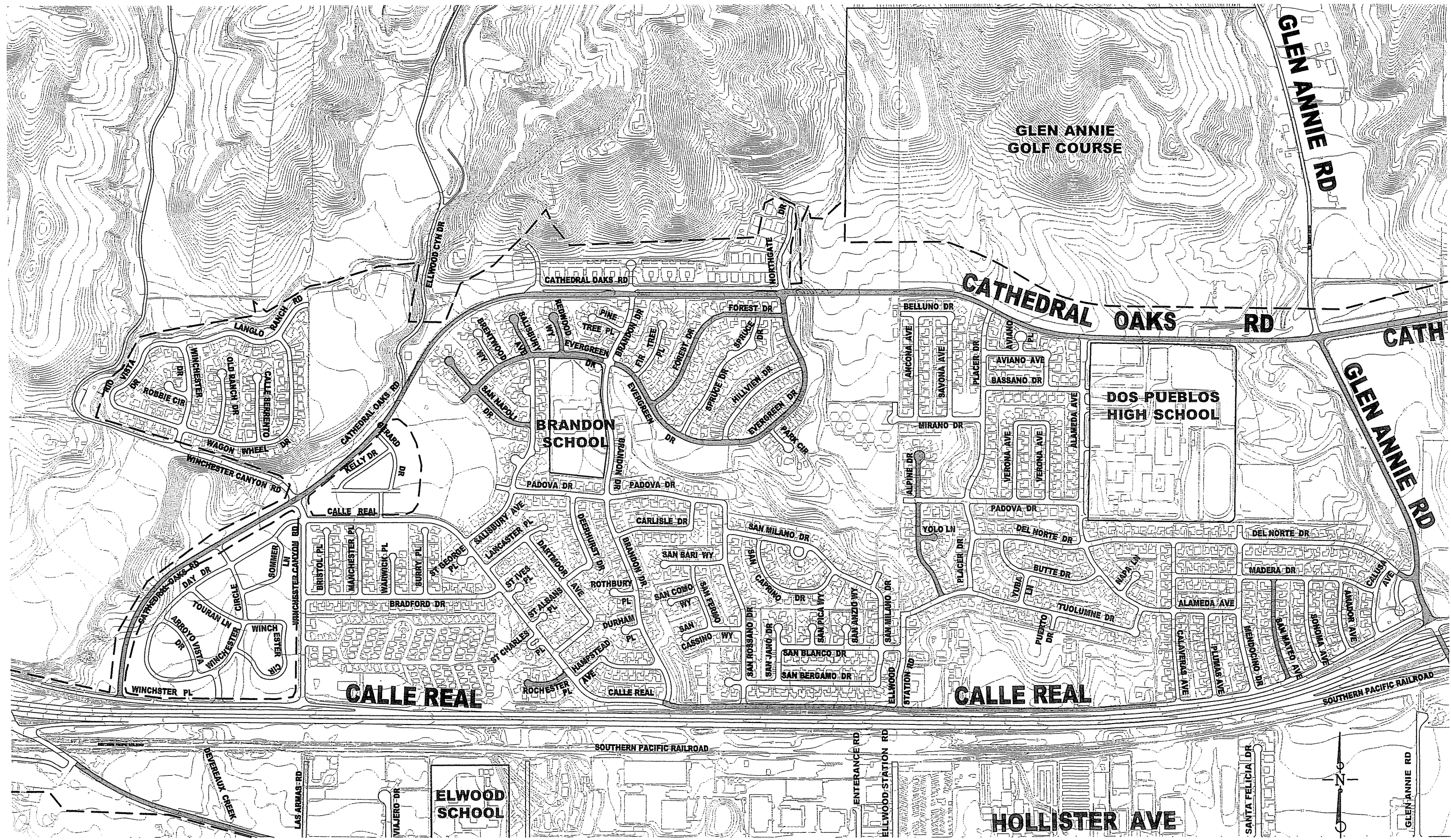

**VICINITY MAP NO. 1**

ALPINE DRIVE, CALLE REAL, CATHEDRAL OAKS ROAD, DEL NORTE DRIVE, EVERGREEN DRIVE, FOREST DRIVE, GLEN ANNIE ROAD, REDWOOD WAY, ROCHESTER PLACE, SALISBURY AVENUE, SAN MATEO AVENUE, SAN NAPOLI DRIVE, YOLO LANE

**FLOWERS & ASSOCIATES, INC.**

CIVIL ENGINEERS

201 North Calle Cesar Chavez, Suite 100 Santa Barbara, California 93103  
Telephone (805) 966-2224



CITY OF GOLETA  
2008/2009  
SLURRY SEAL  
PROJECT

W.O. 0766



Z:\VACADD\WG0766\Slurry-Seal-Maps.dwg, SS-2, 4/16/2008 1:47:29 PM, ssorta, KONICA C450 PCL Copier.pc3, 11x17, 1:1

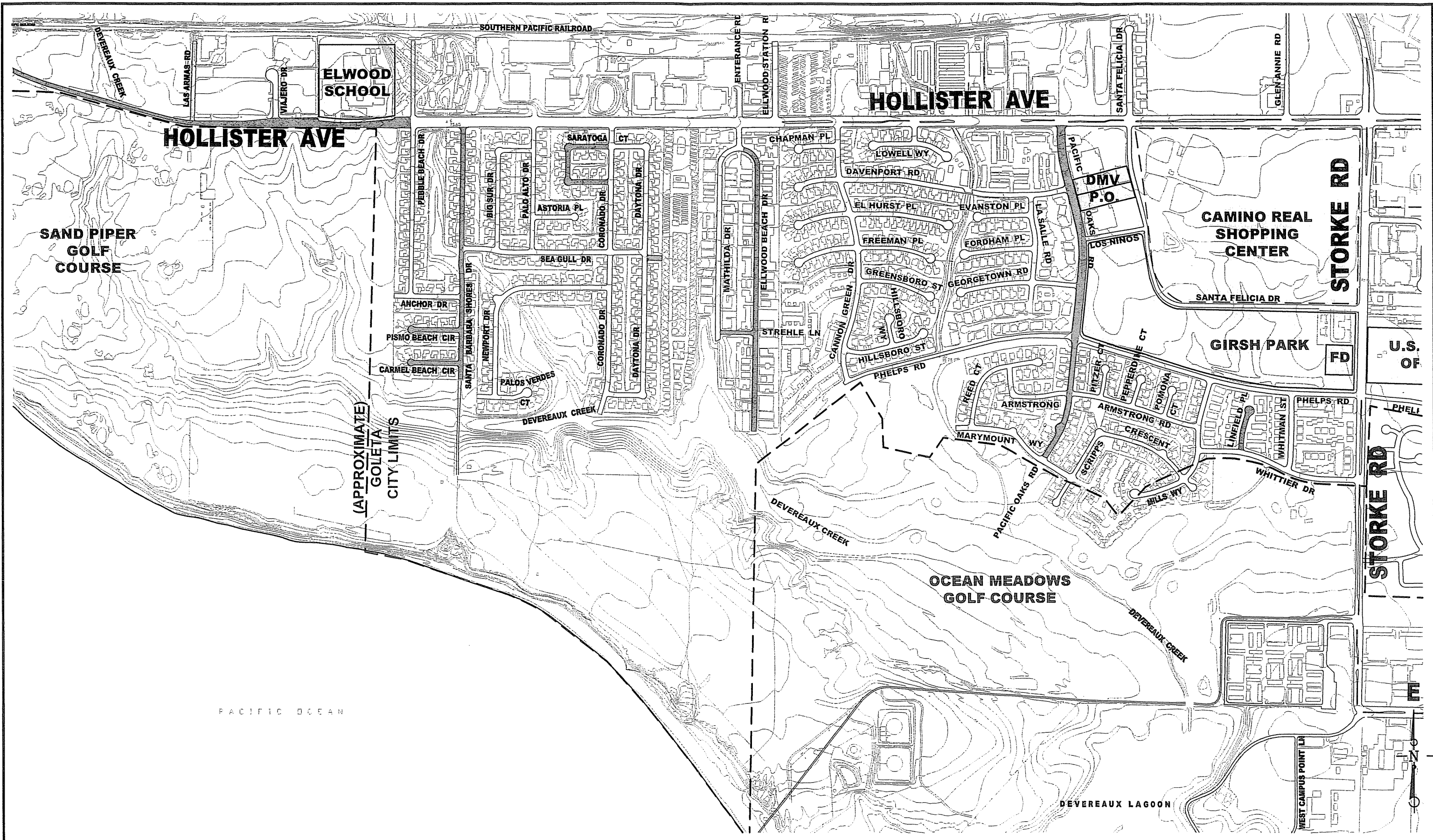

**VICINITY MAP NO. 2**

CARMEL BEACH CIRCLE, ELLWOOD BEACH DRIVE, HOLLISTER AVENUE,  
LINFIELD PLACE, PACIFIC OAKS ROAD, PISMO BEACH CIRCLE,  
SARATOGA COURT, SEA GULL DRIVE, STREHLE LANE

**FLOWERS & ASSOCIATES, INC.**

CIVIL ENGINEERS

201 North Calle Cesar Chavez, Suite 100 Santa Barbara, California 93103  
Telephone (805) 966-2224



**CITY OF GOLETA**

2008/2009  
SLURRY SEAL  
PROJECT

W.O. 0766

Z:\ACADDWG\0766\Slurry-Seal-Maps.dwg, SS-3, 4/16/2008 1:47:46 PM, ssoria, KONICA C450 PCL Copier.pc3, 11x17, 1:1

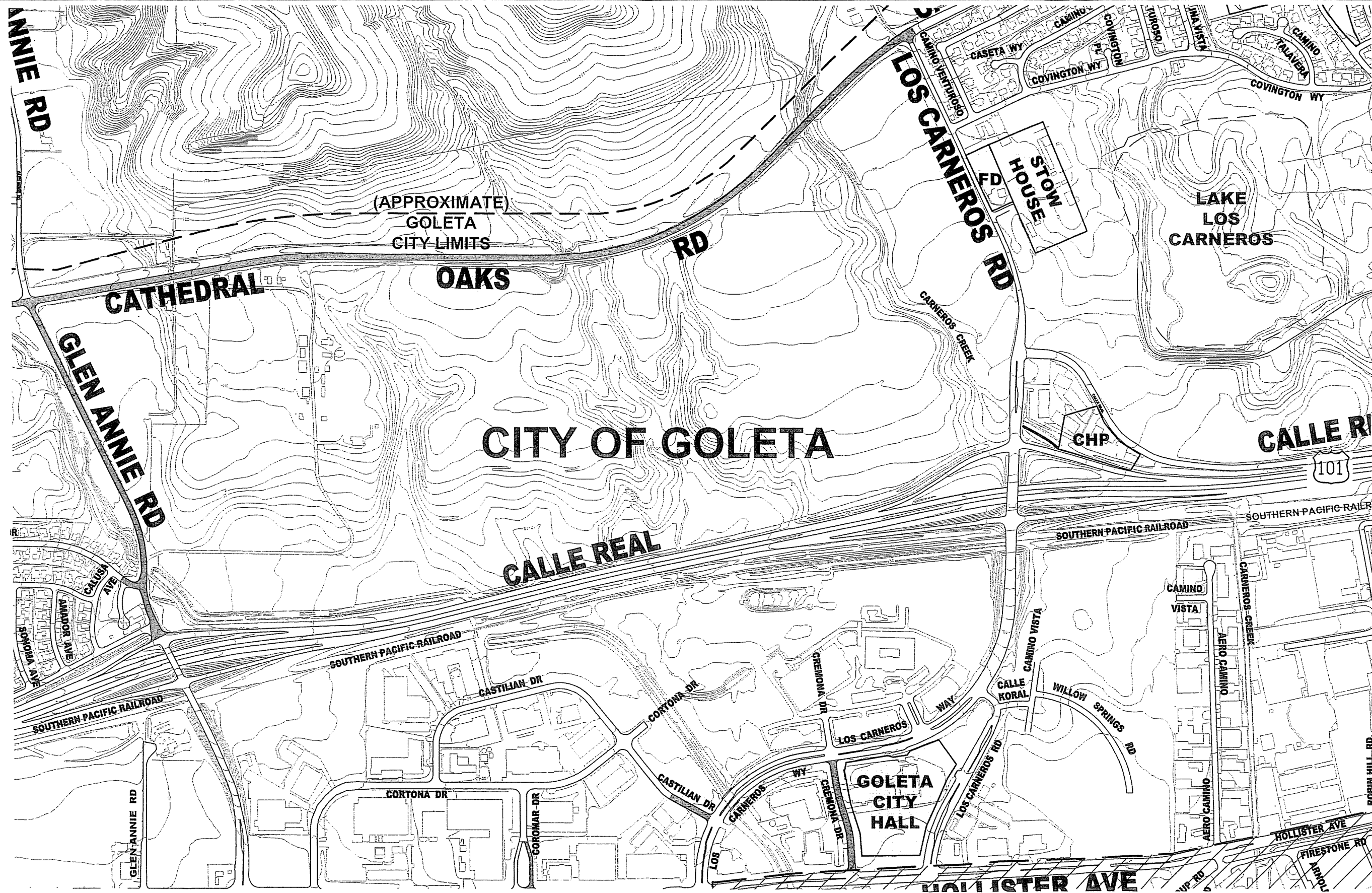

**VICINITY MAP NO. 3**  
 CATHEDRAL OAKS ROAD, CREMONA DRIVE, DEL NORTE DRIVE,  
 GLEN ANNIE ROAD

**FLOWERS & ASSOCIATES, INC.**  
 CIVIL ENGINEERS  
 201 North Calle Cesar Chavez, Suite 100 Santa Barbara, California 93103  
 Telephone (805) 966-2224



CITY OF GOLETA  
 2008/2009  
 SLURRY SEAL  
 PROJECT  
 W.O. 0766



Z:\ACADDWG\0766d\wg0766-Slurry-Seal-Maps.dwg, SS-4, 4/16/2008 1:48:05 PM, ssofia, KONICA C450 PCL Copier.pc3, 11x17, 1:1

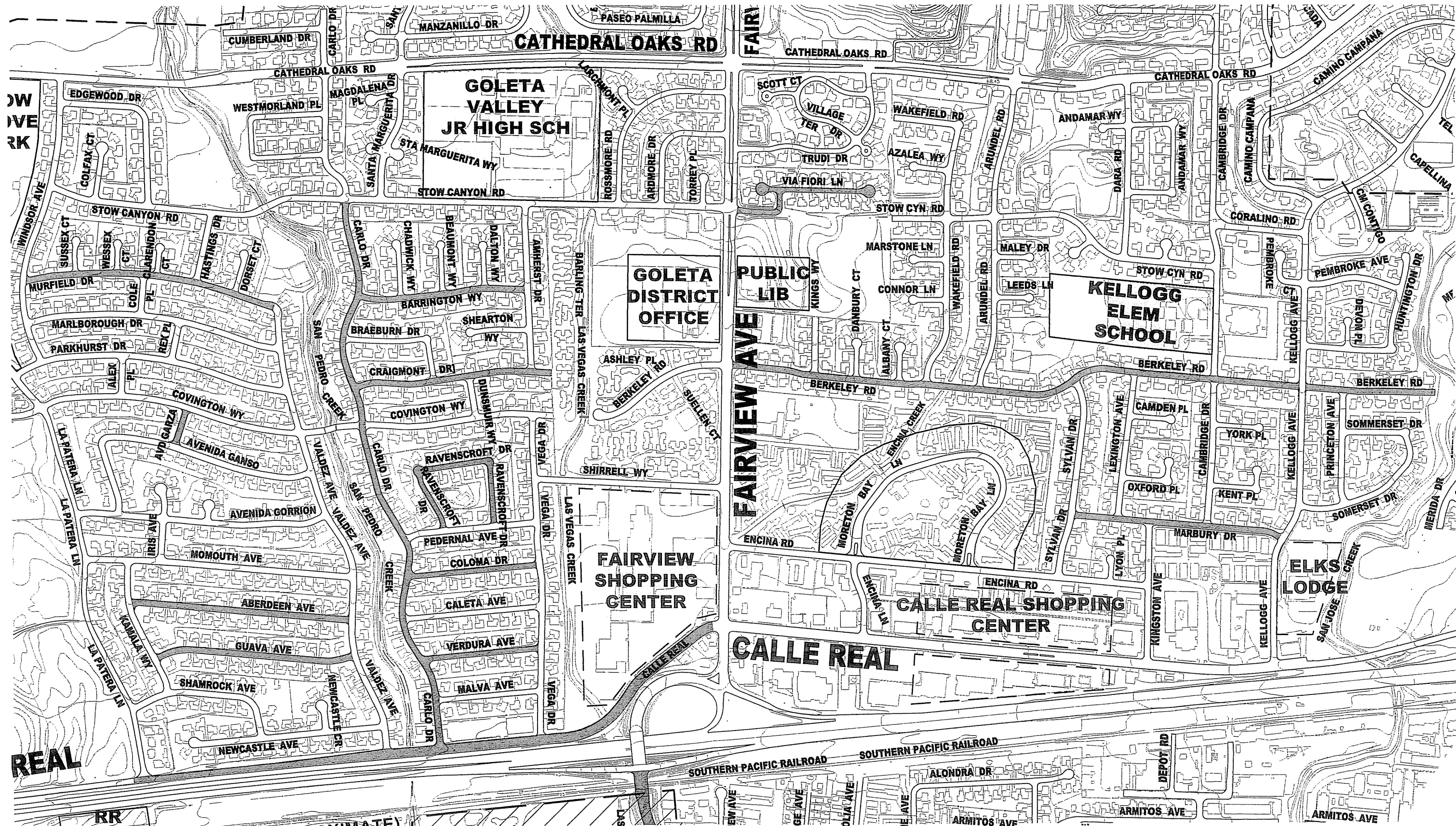

**VICINITY MAP NO. 4**

ABERDEEN AVENUE, AVENIDA GARZA, BARRINGTON WAY, BERKELEY ROAD, CALLE REAL, CARLO DRIVE, COLOMA DRIVE, CRAIGMONT DRIVE, GUAVA AVENUE, MURFIELD DRIVE, RAVENSCROFT DRIVE, STOW CANYON ROAD, VERDURA AVENUE, VIA FIORI LANE

**FLOWERS & ASSOCIATES, INC.**

CIVIL ENGINEERS

201 North Calle Cesar Chavez, Suite 100 Santa Barbara, California 93103  
Telephone (805) 966-2224



CITY OF GOLETA  
2008/2009  
SLURRY SEAL  
PROJECT

W.O. 0766

Z:\ACADDWG\0766d\0766-Slurry-Seal-Maps.dwg, SS-5, 4/16/2008 1:48:24 PM, ssoria, KONICA C450 PCL Copier.pc3, 11x17, 1:1

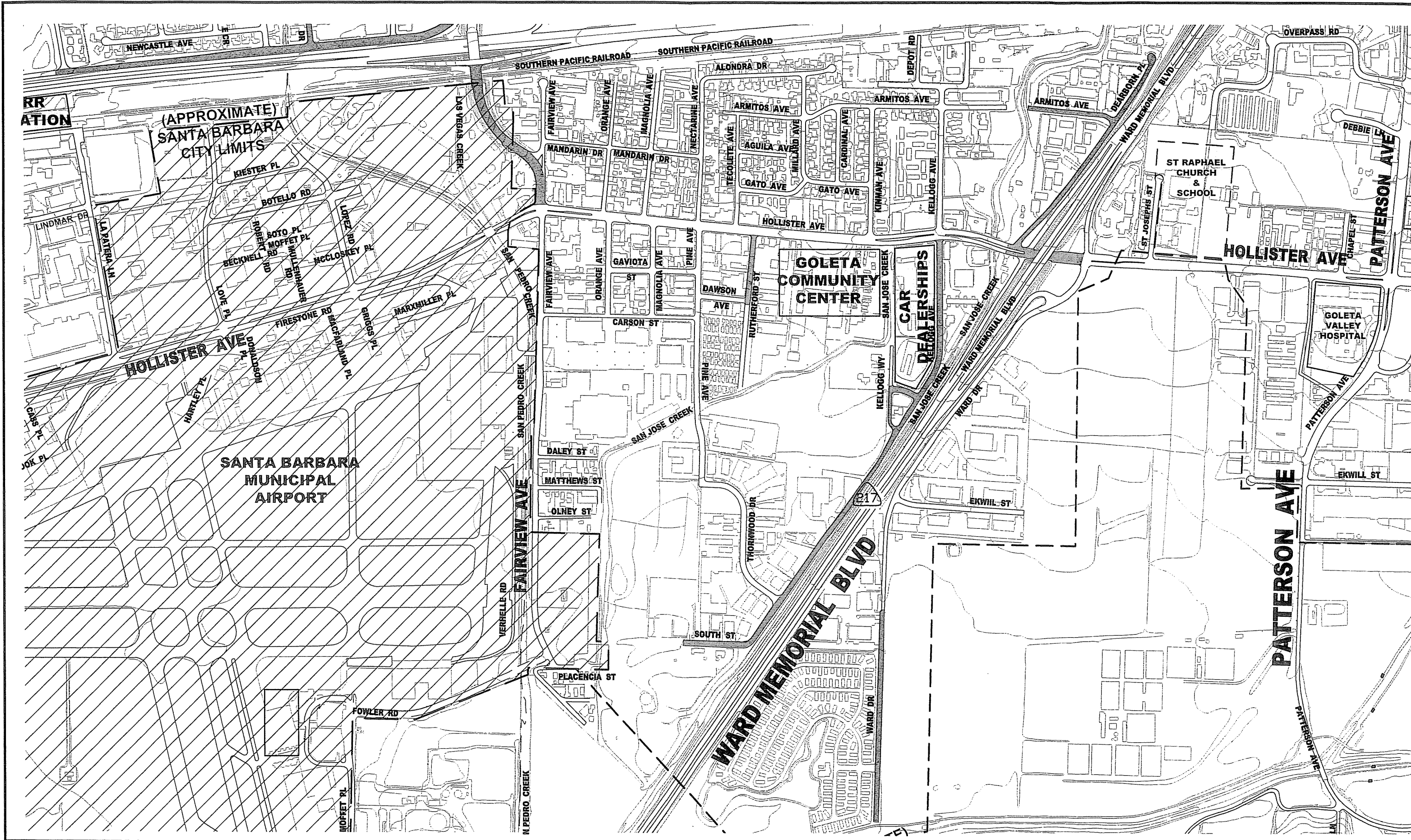

**VICINITY MAP NO. 5**

ARMITOS AVENUE, DEARBORN PLACE, HOLLISTER AVENUE,  
KELLOGG AVENUE, KELLOGG WAY, RUTHERFORD STREET,  
SOUTH STREET, WARD DRIVE

**FLOWERS & ASSOCIATES, INC.**

CIVIL ENGINEERS

201 North Calle Cesar Chavez, Suite 100 Santa Barbara, California 93103  
Telephone (805) 966-2224



CITY OF GOLETA  
2008/2009  
SLURRY SEAL  
PROJECT

W.O. 0766

**ATTACHMENT 3**  
**Detailed Bid Summary**

City of Goleta  
 FY 2008-2009 Pavement Rehabilitation Project  
 Slurry Seal  
 Detailed Bid Summary

Item No.	Description	Unit	Est'd Qty	Bond Blacktop		Valley Slurry Seal		Pavement Coatings Co		Roy Allan Slurry Seal	
1	Mobilization	LS	1	\$100,000.00	\$100,000.00	\$ 20,000.00	\$ 20,000.00	\$20,000.00	\$20,000.00	\$50,000	\$ 50,000.00
2	Slurry Seal City Streets (Type II)	ELT	3,100	\$180.00	\$558,000.00	\$ 244.34	\$ 757,454.00	\$268.50	\$832,350.00	\$266	\$ 824,600.00
3	Slurry Seal City Streets (Type III)	ELT	375	\$195.00	\$73,125.00	\$ 272.00	\$ 102,000.00	\$259.50	\$97,312.50	\$234	\$ 87,750.00
4	Crack Seal City Streets	LS	1	\$78,000.00	\$78,000.00	\$ 154,875.00	\$ 154,875.00	\$130,000.00	\$130,000.00	\$217,250	\$ 217,250.00
5	Traffic Striping, Pavement Markings and Raised Pavement Markers	LS	1	\$94,000.00	\$94,000.00	\$98,700.00	\$98,700.00	\$160,000.00	\$160,000.00	\$205,700	\$ 205,700.00
6	Supplemental Work	LS	1	\$20,000.00	\$20,000.00	\$ 20,000.00	\$ 20,000.00	\$20,000.00	\$20,000.00	\$ 20,000.00	\$ 20,000.00
					<b>\$923,125.00</b>		<b>\$1,153,029.00</b>		<b>\$1,259,662.50</b>		<b>\$1,405,300.00</b>