



DESIGN REVIEW BOARD Staff Report

Agenda Item F-2
Meeting Date: *December 14, 2010*

TO: Goleta Design Review Board
FROM: Brian Hiefield, Assistant Planner; Phone Number: 961-7559
SUBJECT: 10-122-DRB; Christ Lutheran Church Signage
6595 Covington Way; APN 077-160-022

PROJECT DESCRIPTION:

This is a request for *Conceptual/Preliminary/Final* review. The property includes a 2,550-square foot church sanctuary, a 960-square foot classroom, a 900-square foot hall, and a 610-square foot office/nursery/restroom on a 3-acre lot in the 8-R-1 zone district. The applicant proposes to replace the existing freestanding monument sign with an internally illuminated freestanding church changeable copy sign at least 5-feet from the western property line along Los Carneros Road and at a minimum of 20-feet from the corner of Covington Way and Los Carneros Road. The sign structure will measure a maximum of 4-feet high by 6-feet long for an aggregate of 24 square feet. There will be 6 lines available for the 4-inch high changeable copy that will give worship times, and other announcements. The project was filed by agent Bruce Trowbridge on behalf of Christ Lutheran Church of Goleta, property owner. Related cases: 10-122-SCC; 10-122-LUP.

ISSUES:

- **Sign Ordinance Section:** The sign ordinance specifies to use perimeter lighting for changeable copy signs. Discuss and consider more modern form of internal LED illumination as proposed by the applicant.
Perimeter Lighting – Definition: A subdued method of illuminating a sign without illuminating the area outside the sign.

ATTACHMENTS:

- Reduced 11" x 17" copies of site plans and elevations.

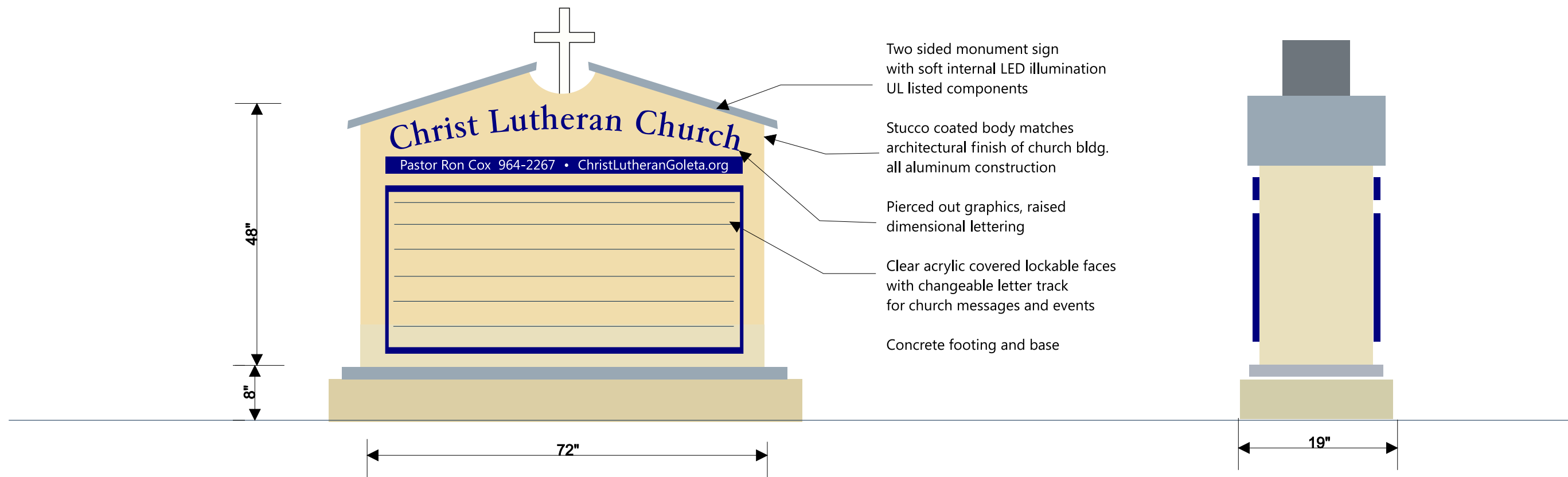

Design No:

Account:
Christ Lutheran Church

Location:
Goleta, Ca

Designer:
Dave

Date:
6-14-10

Revised:

Fonts:

This is an original unpublished drawing, submitted for the project being planned. This drawing is not to be copied or shown to persons outside of your organization without the written permission of Dave's Signs

Approvals as required:

Client:

Landlord:

Clients approval signature certifies that spelling, colors and all other specifications are correct as detailed and set forward herein.

Dave's Signs Rep.:

E-mail:
dave@davessigns.com

Cell:

1982 E. Thompson Blvd.
Ventura, CA 93001

Ph: (805) 641-1387

Fx: (805) 641-0397

Lic C-45 # 917812

Footing detail

4' diameter x 1/4" pole set in concrete footing and pad

Sign attachment detail

1/2" thru bolt galvanized thru 4" diameter x 1/4" wall pipe brackets welded to internal frame

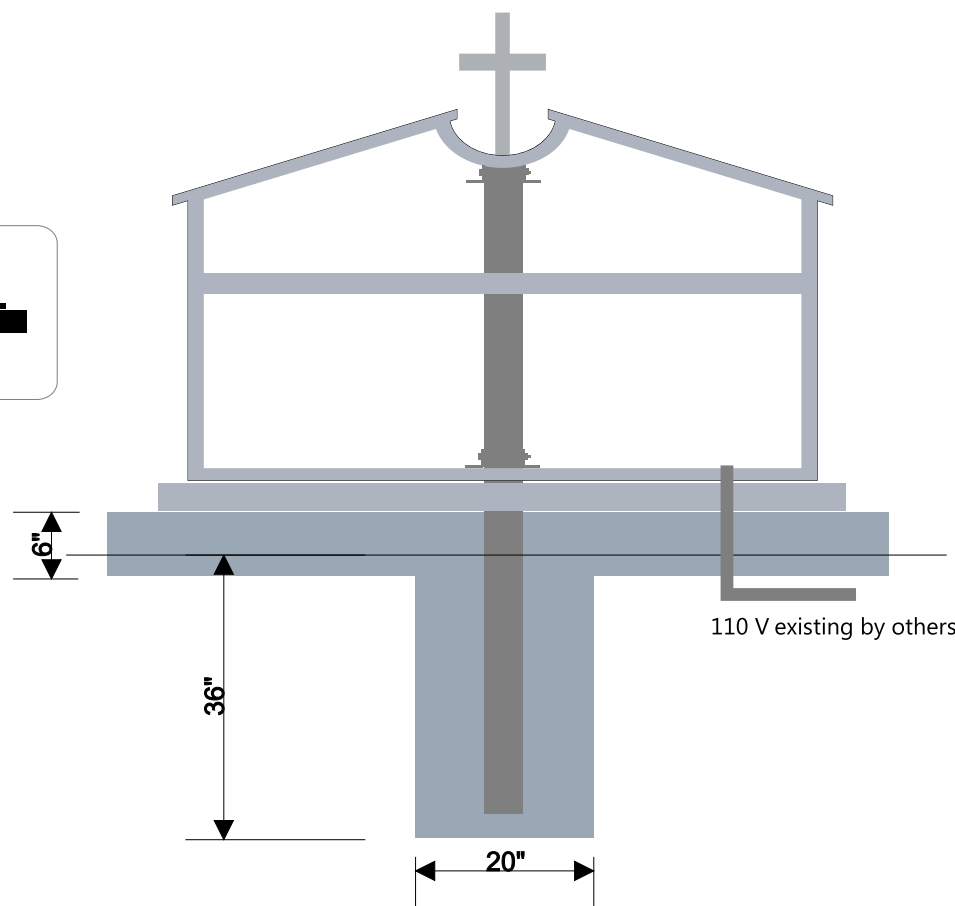
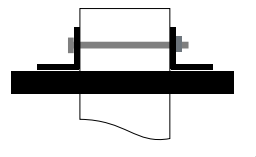

UL Listed sign cabinet and components
Installed to NEC2008 Specifications

COUINGTON WAY

COV11

76'

280.00' S 63° 53' 23" E

75'

EXISTING PLAYGROUND

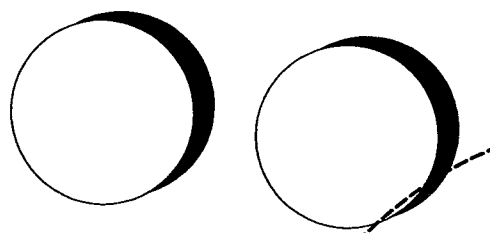
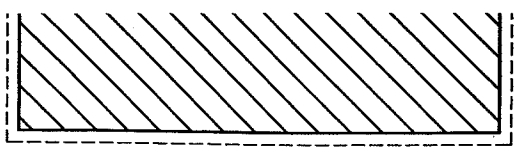

Temporary Overflow P for Stowe (approx. 1')

Existing T

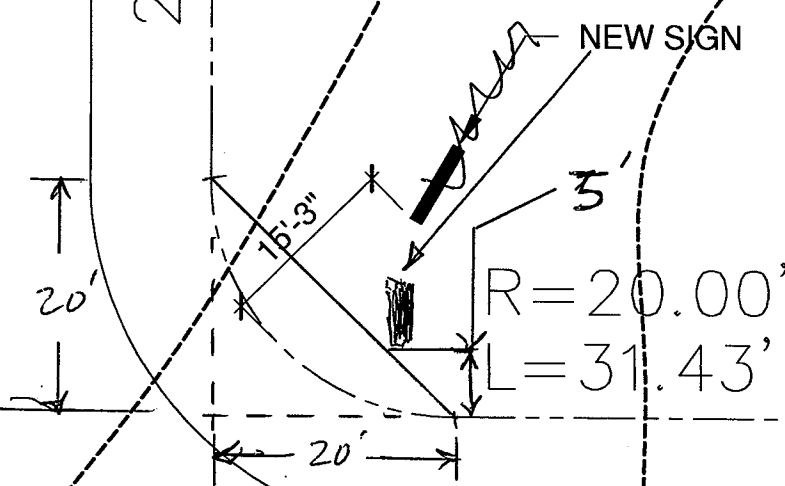

PROPERTY LINE

415.60' N 2

Bruce Trombadori
Bruce Trombadori

SITE PLAN

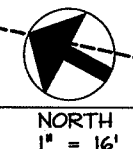

NORTH
1" = 16'

11/29/2010

LOS CARNEROS ROAD