



Agenda Item B.2
CONSENT CALENDAR
Meeting Date: June 3, 2008

TO: Mayor and Councilmembers

FROM: Steve Wagner, Community Services Director

CONTACT: Marti Schultz, Principal Civil Engineer

SUBJECT: Construction Contract for the FY 2008-09 Pavement Rehabilitation Project, Phase 1 - Pavement Preparation

RECOMMENDATION:

- A. Authorize the City Manager to execute a construction contract for Phase 1 of the FY 2008-09 Pavement Rehabilitation Project, Pavement Preparation, to Berry General Engineering, Inc., in the amount of \$500,524 subject to the requirements of the contract documents.
- B. Authorize the City Manager to approve contract change orders as necessary for Phase 1 of the FY 2008-09 Pavement Rehabilitation Project, Pavement Preparation, in an amount not to exceed \$100,000.
- C. Authorize the City Manager to execute a professional services agreement with Flowers and Associates, Inc. for construction management, inspection and material testing services for the Pavement Preparation and Slurry Seal projects in an amount not to exceed \$216,961.

BACKGROUND:

On December 3, 2007, the City Council authorized the execution of a professional services agreement with Flowers & Associates, Inc. (Flowers) for the design of the FY 2008-09 Pavement Rehabilitation Project. The Pavement Rehabilitation Project is divided into two phases: Phase 1 - Pavement Preparation and Phase 2 – Slurry Seal.

The pavement preparation contract is to repair any failed pavement areas prior to the application of a slurry seal. Not all streets that receive slurry seal require pavement preparation; however all of the streets that are included in the Pavement Preparation contract will be included in the Slurry Seal project.

The list of streets included in the Pavement Preparation Project is shown in Attachment 1 and a vicinity map showing the areas of work is provided in Attachment 2.

DISCUSSION:

Pavement Preparation

This Council agenda item is for the award of Phase 1 - Pavement Preparation. Staff will return with the recommendation for the award of Phase 2 – Slurry Seal on June 17, 2008.

Bids for the Pavement Preparation Project were opened on May 21, 2008. A total of three (3) bids were received. The engineer’s estimate for the project was \$616,000. The low bid submitted was from Berry General Engineer, Inc. (Berry) in the amount of \$500,524. A summary of the bids received is shown below and a copy of the detailed bid results is Attachment 3 of this report.

Contractor	Office Location	Bid Amount
Berry General Engineering, Inc.	Ventura	\$500,524
Granite Construction Company	Santa Barbara	\$538,966
Lash Construction	Santa Barbara	\$580,937

Berry is a qualified firm that specializes in pavement repairs. They have completed similar City projects on time and within budget. Based on the bids submitted and the previous experience, staff recommends award of a construction contract for the Pavement Preparation Project to Berry.

Professional Services Agreement

The total estimated cost for construction of the Pavement Rehabilitation projects is \$2.0 million. Construction management, inspection and testing (CMI&T) services are proposed to be provided by Flowers & Associates, Inc. (Flowers) in an amount not to exceed \$216,961 for both the Pavement Preparation and Slurry Seal projects. The CMI&T services is approximately 11% of the estimated construction cost which is in line with the industry standard for these types of projects. Staff recommends that a single professional services agreement for both projects in an amount not to exceed \$216,961, be approved. Flowers provided the inspection services on the FYs 2005-2006 and 2007-2008 Pavement Rehabilitation Projects and completed the projects within budget. Their staff is familiar with the City’s needs and expectations in performing the requested services.

GOLETA STRATEGIC PLAN:

The FY 2008-09 Pavement Rehabilitation Project, Phase 1 - Pavement Preparation is consistent with the Goal in the Goleta Strategic Plan entitled,

“Prioritize Maintenance of City Streets, Parks & Facilities.” Specifically, this project meets Objective “Street Improvement and Reinvestment Program” and moves the City closer toward realizing its vision as defined within the City’s Strategic Plan.

ALTERNATIVES:

The Council may reject all bids for the project and direct staff to re-bid. However, doing so would result in a delay in the proposed street improvement program and an increase to the overall projects costs.

FISCAL IMPACTS:

The amended FY 2008-09 Budget includes approximately \$2.1 million for pavement rehabilitation as part of the City’s Street Improvement and Reinvestment Program. Since the bids came in lower than estimated, staff is recommending a 20% change order authority for the Pavement Preparation contract. This change order authority will allow for more streets to be rehabilitated this fiscal year. The additional change order authority will not exceed the proposed budget for the Fiscal Year 2008-09 Pavement Rehabilitation Project as shown in the table below:

PHASE 1 – PAVEMENT PREPARATION				
Fund and Acct. Number	Construction Contract	Change Order	Inspection	Totals
Measure D 205-5-5800-413	\$245,524	\$100,000	\$72,320	\$417,844
Gas Tax 201-5-5800-413	\$255,000			\$255,000
Total	\$500,524	\$100,000	\$72,320	\$672,844

Award of the construction contract to Berry for Phase 1 – Pavement Preparation as recommended will result in the improvement of approximately 24.6 lane miles on 44 separate street sections in the City.

Submitted By:

Reviewed by:

Approved By:

Steve Wagner
Community Services
Director

Michelle Greene
Administrative Services
Director

Daniel Singer
City Manager

ATTACHMENTS:

1. List of streets to be included in Pavement Preparation Project
2. Vicinity Map Pavement Preparation
3. Pavement Preparation Project Bid Summary
4. Proposal for Engineering Construction Services from Flowers & Assoc., Inc.

ATTACHMENT 1

**List of Streets to be included in the
Pavement Preparation Project**

2008/2009 Pavement Rehabilitation - Pavement Preparation
List of Streets

STREET	FROM	TO
Aberdeen	E/S Kamala Avenue	W/S Valdez Avenue
Alpine Drive	N/S Tuolumne Drive	S/S Padova Drive
Avenida Garza	S/S Covington Way	N/S Avenuenida Ganso
Barrington Way	E/S Carlo Drive	W/S Amherst Drive
Berkeley	E/S Fairview Avenue	End
Calle Real	Daffodil Drive	W/S Brandon Drive
Calle Real	La Patera	W/S Fairview Avenue
Carlo Drive	S/S Stow Canyon Road.	N/S Calle Real
Carmel Beach Circle	W/S Santa Barb. Shores	CDS
Castillian Drive	W/S Los Carneros Way	420' W/O Los Carneros
Cathedral Oaks Road	Calle Real	E/S Los Carneros
Coloma Drive	E/S Carlo Drive	W/S Vega Drive
Coromar Drive	N/S Hollister Avenue	270' N/O Hollister Avenue
Craigmont Drive	E/S Carlo Drive	East End
Cremona Drive	S/S Los Carneros Road	N/S Hollister Avenue
Dearborn Pl	N/S Hollister Avenue	CDS
Del Norte Drive	180' W/O Glen Annie Road	W/S Glen Annie Road
Ellwood Beach Drive	E/S Entrance Drive	End
Evergreen Drive	E/S Brandon Drive	Cathedral Oaks
Evergreen Drive	W/S Brandon Drive	West End
Fairview Avenue	S/S 101 Bridge Deck	N/S Hollister Avenue
Forest Drive	N/S Evergreen Drive	W/S Evergreen Drive
Glenn Annie Road	N/S Calle Real	Cathedral Oaks
Guava Avenue	E/S Kamala Way	W/S Valdez Avenue
Hollister Avenue	Dearborn Drive	W/S Ward Drive
Hollister Avenue	Pebble Beach Drive	Viajero Drive
Hollister Avenue	W/S ViaJero Drive	S/S 101 Bridge Deck
Kellogg Avenue	S/S Hollister Avenue	110' S/O Kellogg Place
Kellogg Place	E/S Kellogg Way	W/S Kellogg Avenue
Kellogg Way	N/S Kellogg Avenue	North End
Linfield Place	N/S Whittier Drive	CDS
Marbury Drive	W/S Kellogg Avenue	E/S Sylvan Drive
Murfield Drive	E/S Windsor Avenue	W/S Valdez Avenue
Pacific Oaks Road	S/S Hollister Avenue	N/S Marymount
Pismo Beach Circle	W/S Santa Barbara Shores	CDS
Ravenscroft	N/S Pedernal Avenue	N/S Pedernal Avenue
Redwood Way	N/S Evergreen Drive	CDS
Rochester Place	W/S Calle Real	CDS
Rutherford	Hollister Avenue	S/S Dawson Street
Salisbury Avenue	N/S Evergreen Drive	CDS
San Mateo Avenue	S/S Madera Drive	N/S Calle Real
San Napoli Drive	Evergreen	CDS
San Napoli Drive	S/S Evergreen Drive	W/S Salisbury Avenue
Santa Barbara Shores	S/S Hollister Avenue	End
Saratoga Ct	W/S Coronado	W/S Coronado
Storke Road	N/S Hollister Avenue	S/S 101 Bridge Deck
Stow Canyon Road	E/S Fairview Avenue	Via Fiori
Strehle Lane	E/S Mathilda	W/S Ellwood Beach Drive
Verdura Avenue	E/S Carlo	W/S Vega Drive
Via Fiori	East CDS	West CDS
Ward Drive	3510' S/O Hollister Avenue	South End
Yolo Lane	Alpine	CDS

ATTACHMENT 2

Vicinity Maps

Z:\ACADDWG\0766-Slurry-Seal-Maps.dwg, PP-1, 4/16/2008 1:45:34 PM, ssoria, KONICA C450 PCL Copier.pcs, 11x17, 1:1

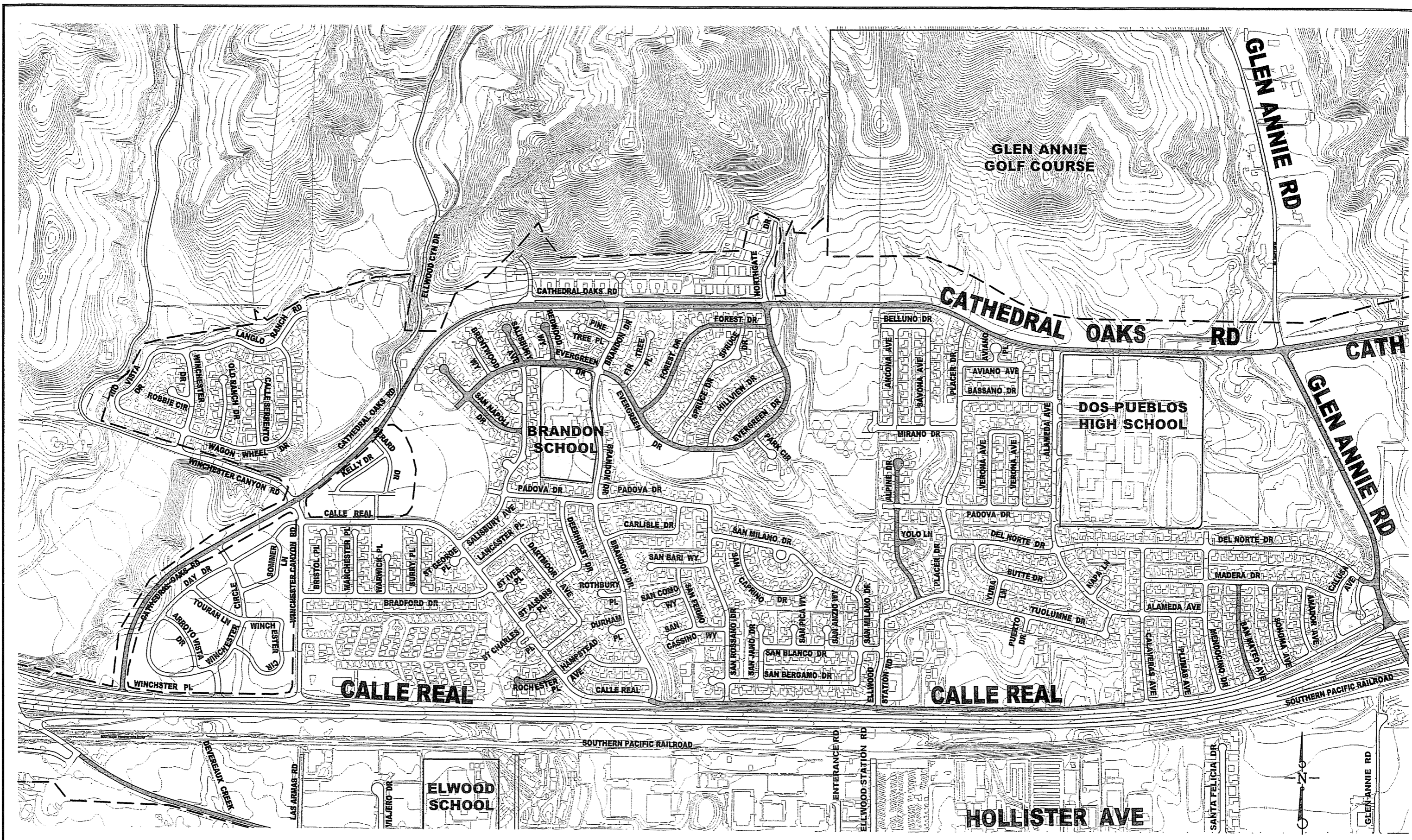

VICINITY MAP NO. 1

ALPINE DRIVE, CALLE REAL, CATHEDRAL OAKS ROAD, DEL NORTE DRIVE, EVERGREEN DRIVE, FOREST DRIVE, GLEN ANNIE ROAD, REDWOOD WAY, ROCHESTER PLACE, SALISBURY AVENUE, SAN MATEO AVENUE, SAN NAPOLI DRIVE, YOLO LANE

FLOWERS & ASSOCIATES, INC.

CIVIL ENGINEERS

201 North Calle Cesar Chavez, Suite 100 Santa Barbara, California 93103
Telephone (805) 966-2224



CITY OF GOLETA
2008/2009
PAVEMENT PREPARATION
PROJECT
W.O. 0766

Z:\ACADDWG\0766\dwg\0766-Slurry-Seal-Maps.dwg, PP-2, 4/16/2008 1:45:51 PM, ssortia, KONICA C450 PCL Copier.pc3, 11x17, 1:1

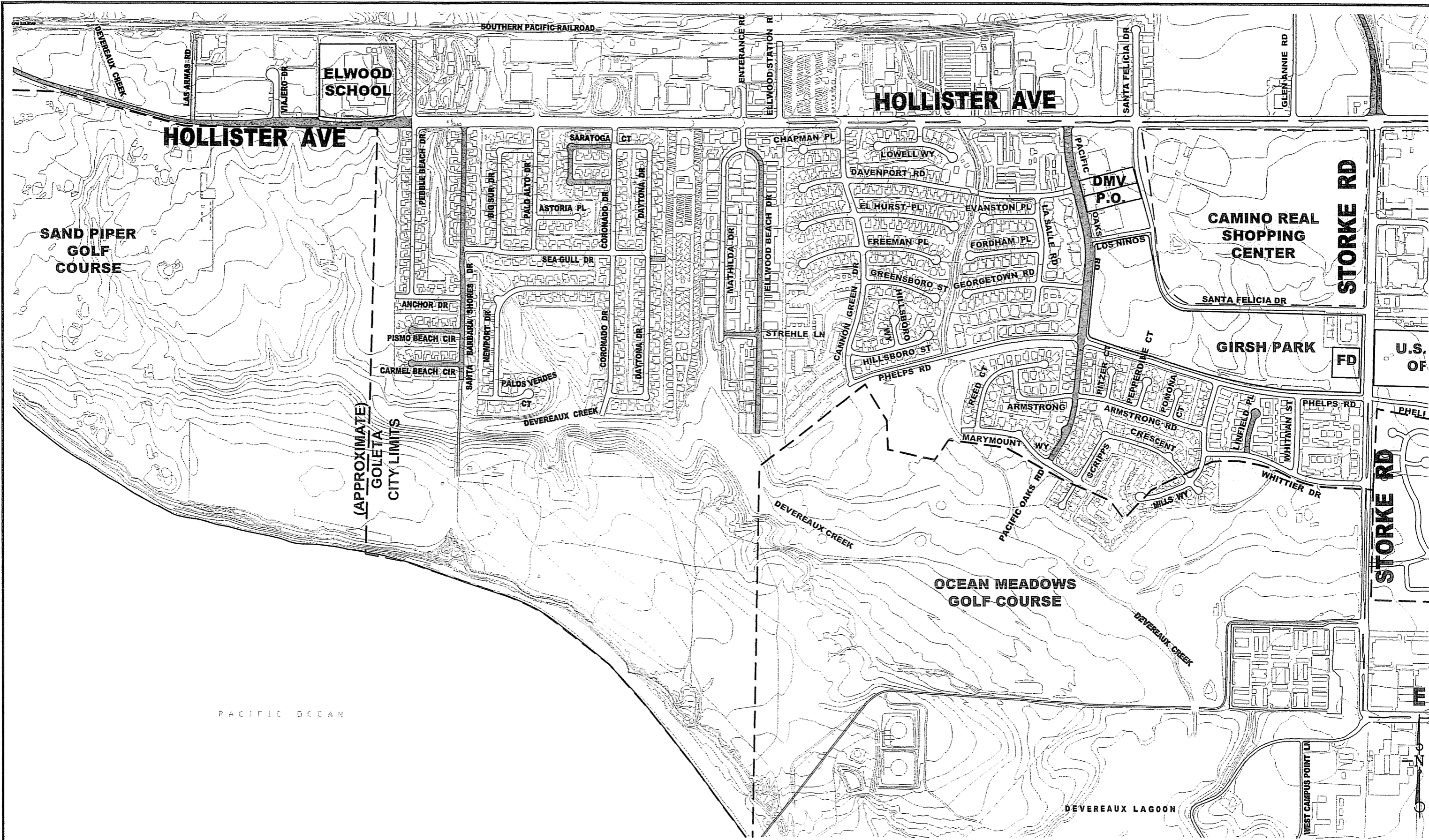

VICINITY MAP NO. 2

CARMEL BEACH CIRCLE, ELLWOOD BEACH DRIVE, HOLLISTER AVENUE,
LINFIELD PLACE, PACIFIC OAKS ROAD, PISMO BEACH CIRCLE,
SARATOGA COURT, SEA GULL DRIVE, STREHLE LANE

FLOWERS & ASSOCIATES, INC.

CIVIL ENGINEERS

201 North Calle Cesar Chavez, Suite 100 Santa Barbara, California 93103
Telephone (805) 966-2224



CITY OF GOLETA
2008/2009
PAVEMENT PREPARATION
PROJECT

W.O. 0766

Z:\ACADDWG\0766\Slurry-Seal-Maps.dwg, PP-3, 4/16/2008 1:46:09 PM, ssortia, KONICA C450 PCL Copier.pc3, 11x17, 1:1

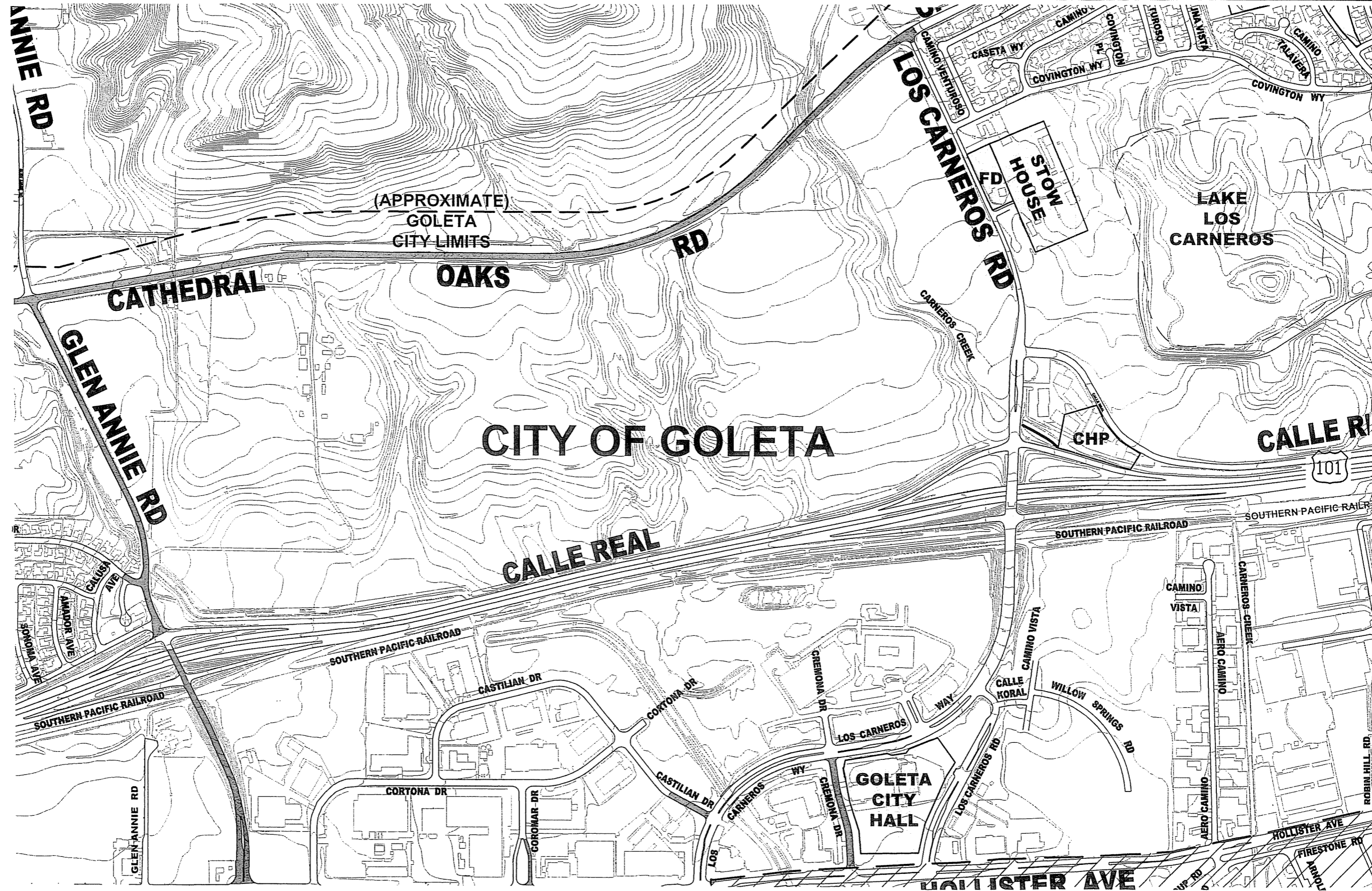

VICINITY MAP NO. 3
 CATHEDRAL OAKS ROAD, CREMONA DRIVE, DEL NORTE DRIVE,
 GLEN ANNIE ROAD

FLOWERS & ASSOCIATES, INC.
 CIVIL ENGINEERS
 201 North Calle Cesar Chavez, Suite 100 Santa Barbara, California 93103
 Telephone (805) 966-2224



CITY OF GOLETA
 2008/2009
 PAVEMENT PREPARATION
 PROJECT
 W.O. 0766

Z:\ACADD\WG\0766\Slurry-Seal-Maps.dwg, PP-4, 4/16/2008 1:46:28 PM, ssortia, KONICA C450 PCL Copier.pc3, 11x17, 1:1

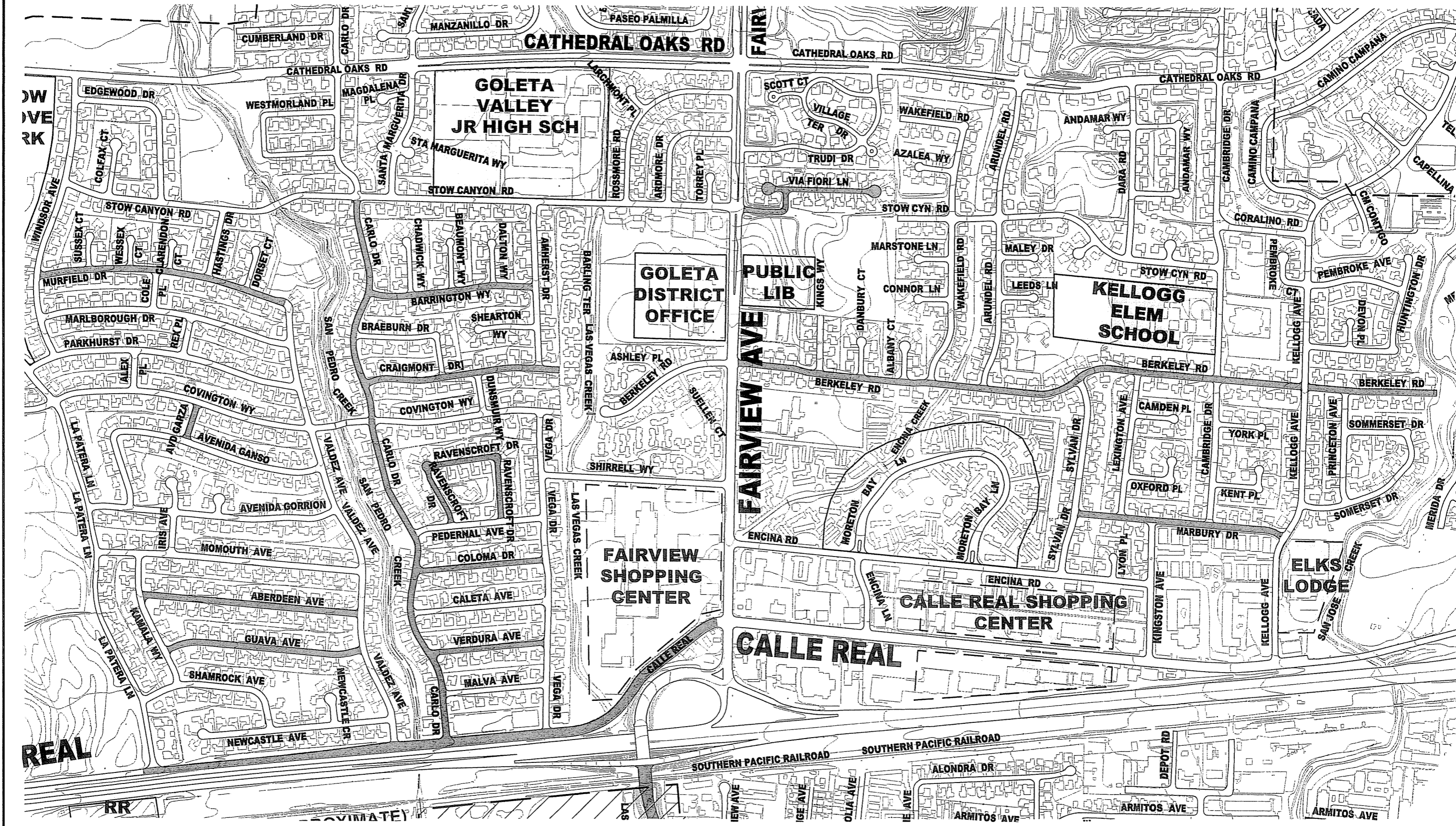

VICINITY MAP NO. 4

ABERDEEN AVENUE, AVENIDA GARZA, BARRINGTON WAY, BERKELEY ROAD, CALLE REAL, CARLO DRIVE, COLOMA DRIVE, CRAIGMONT DRIVE, GUAVA AVENUE, MURFIELD DRIVE, RAVENSCROFT DRIVE, STOW CANYON ROAD, VERDURA AVENUE, VIA FIORI LANE

FLOWERS & ASSOCIATES, INC.

CIVIL ENGINEERS

201 North Calle Cesar Chavez, Suite 100 Santa Barbara, California 93103
Telephone (805) 966-2224



CITY OF GOLETA
2008/2009
PAVEMENT PREPARATION
PROJECT
W.O. 0766

Z:\ACADDWG\0766\Slurry-Seal-Maps.dwg, PP-5, 4/16/2008 1:46:47 PM, ssoria, KONICA C450 PCL Copier.pc3, 11x17, 1:1

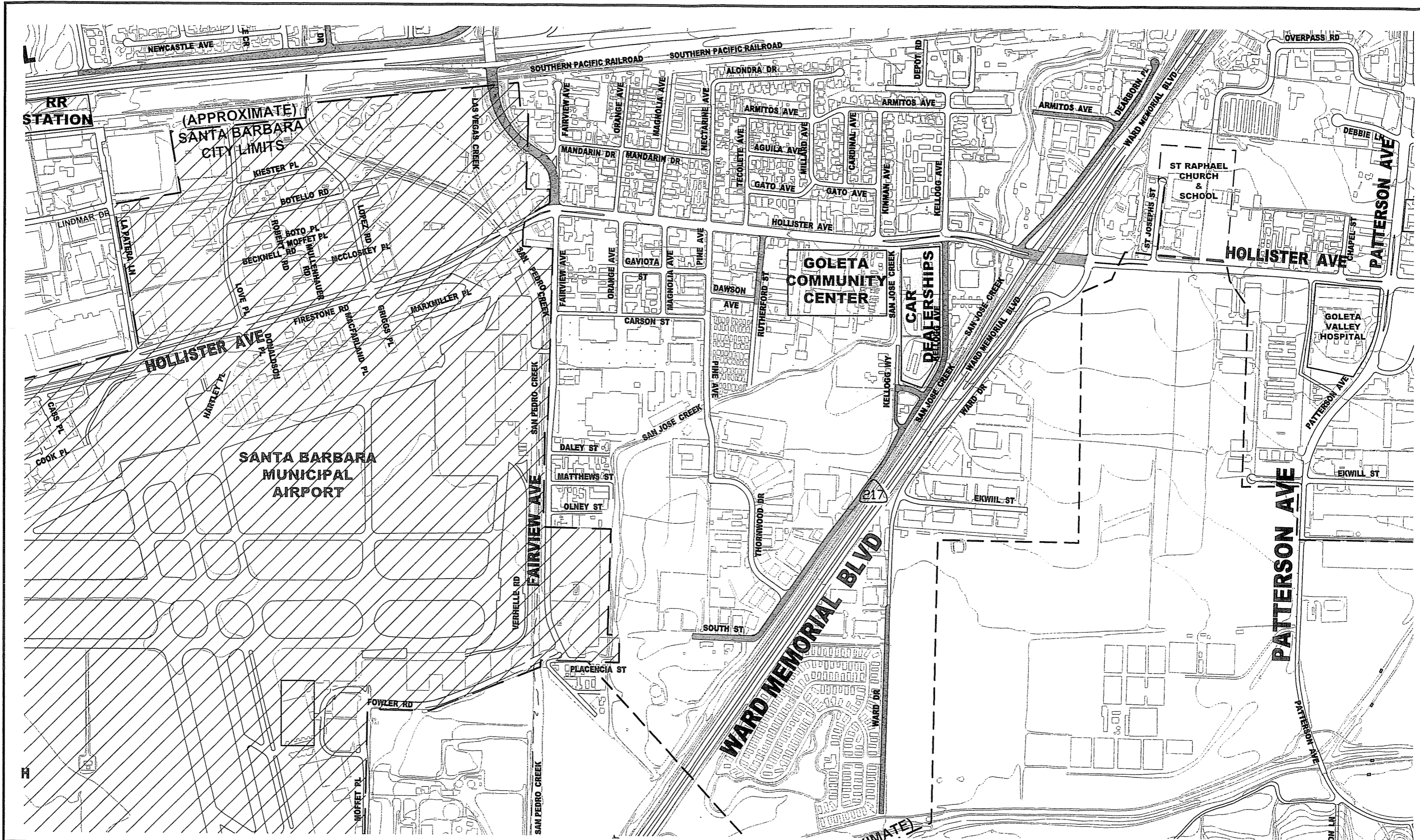

VICINITY MAP NO. 5

ARMITOS AVENUE, DEARBORN PLACE, HOLLISTER AVENUE, KELLOGG AVENUE, KELLOGG WAY, RUTHERFORD STREET, SOUTH STREET, WARD DRIVE

FLOWERS & ASSOCIATES, INC.

CIVIL ENGINEERS

201 North Calle Cesar Chavez, Suite 100 Santa Barbara, California 93103
Telephone (805) 966-2224



CITY OF GOLETA
2008/2009
PAVEMENT PREPARATION
PROJECT
W.O. 0766

ATTACHMENT 3

Pavement Preparation Project Bid Summary

City of Goleta
 FY 2008-2009 Pavement Rehabilitation Project
PAVEMENT PREPARATION
 Detailed Bid Summary

			Berry General		Granite Construction		Lash Construction		
Item	Unit	Est'd Qty							
1	Move in/out bonds and insurance	LS	1	\$7,600.00	\$7,600.00	\$30,000.00	\$30,000.00	\$28,908.00	\$28,908.00
2	Traffic Control	LS	1	\$46,880.00	\$46,880.00	\$34,991.00	\$34,991.00	\$62,469.00	\$62,469.00
3	Asphalt concrete spot leveling	SF	9,700	\$4.20	\$40,740.00	\$2.00	\$19,400.00	\$2.09	\$20,273.00
4	2" Grind and replace asphalt concrete	SF	85,700	\$4.22	\$361,654.00	\$4.75	\$407,075.00	\$4.92	\$421,644.00
5	9" Grind and replace asphalt concrete**	SF	1,100	\$21.50	\$23,650.00	\$25.00	\$27,500.00	\$25.13	\$27,643.00
6	Supplemental Work	LS	1	\$20,000.00	\$20,000.00	\$20,000.00	\$20,000.00	\$20,000.00	\$20,000.00
					\$500,524.00		\$538,966.00		\$580,937.00

ATTACHMENT 4

**Proposal for Engineering Construction Services
from Flowers & Associates, Inc.**

FLOWERS & ASSOCIATES, INC.

C I V I L E N G I N E E R S

201 NORTH CALLE CESAR CHAVEZ, SUITE 100, SANTA BARBARA, CA 93103

PHONE: 805.966.2224 • FAX: 805.965.3372

www.flowersassoc.com

Robert T. Flowers
RCE 16324
Stephen G. Flowers
RCE 26192
Vernon E. Williams
RCE 33660
Eric L. Flavell
RCE 33000



W.O. 0766C

May 20, 2008

Ms. Marti Schultz
City of Goleta
Community Services Department
130 Cremona Drive Suite B
Goleta, CA 93117

Subject: Proposal for Engineering Construction Services for the City of Goleta FY 2008/2009 Pavement Rehabilitation Project including Pavement Preparation, and Slurry Seal

Dear Marti:

Pursuant to your request, we are pleased to submit this proposal for Engineering Construction Services for the FY 2008/2009 Pavement Preparation Project and Slurry Seal Project.

Firm Experience with City

Flowers & Associates Inc. has performed construction services for all phases of pavement rehabilitation for the past four fiscal years and pavement maintenance design services for preparing contract documents and method of repair for the past five fiscal years, following the projects through all phases of construction.

Working with City staff, we have developed an approach which significantly upgrades the streets and stretches the City's maintenance dollars. The knowledge we have gained from the previous four years programs have been included into this year's construction contract documents in an effort to provide the City with a quality finished product while both educating the public and reducing public inconvenience. Each cycle we are involved with allows us to become more efficient and proficient at providing these services to the City within contract time and typically under budget.

We have gained significant experience with public outreach and representing the City and street maintenance in a positive light. We have spent time explaining phases of work to inquiring citizens and that the project funding for the street work is provided in part by Measure D. We have past experience with many of the contractors listed on the Bidders List for both Pavement Preparation and Slurry Seal projects. We have a clear understanding of the City's desire to reduce impacts to residents, provide advanced notification with both postings and door hangers. We make every reasonable attempt to contact/locate vehicle owners to avoid

towing vehicles, but when towing is required, we will work with Greg Nordyke, the City's Code Enforcement Officer.

Proposed Services

This proposal consists of providing services for two types of street maintenance construction projects. The first is Pavement Preparation; this treatment includes point repairs at various locations throughout the City to bring the selected streets up to a reasonable condition in preparation for slurry seal. The second is Slurry Seal; this treatment consists of slurry sealing the selected City streets to preserve the streets and provide a new wear surface. Full services have been requested by the City which consists of contract administration, construction review and observation and project documentation. We have prepared this proposal to provide these services for both the Pavement Preparation and the Slurry Seal construction contracts.

Pavement Preparation:

The Pavement Preparation phase of construction work is expected to start in late June and will have a contract period of 40 working days. The project will consist of three types of pavement repair including: spot leveling of approximately 9,700 square feet; 2" grind and replacement of approximately 85,700 square feet; and approximately 400 square feet of 9" grind and A.C. replacement at various locations throughout the City. The bid opening is scheduled for May 21, 2008 with an engineer's opinion of estimated construction cost of \$616,000.

Slurry Seal:

The Slurry Seal phase of construction work is expected to start in early August and has a contract period of 65 working days. The project will consist of three phases of work: weed kill, crack sealing for street preparation, and slurry seal including Type 2 and Type 3 slurries. Selected streets will receive both types of slurry (Type II and Type III). Type 3 will be applied first to a total of approximately 294,000 square feet. Type 2 will be applied subsequent to type 3 and will include approximately 3,500,000 square feet at various locations throughout the City. Fugro West, Inc. will be the Laboratory performing testing for the slurry phase only. See proposal dated May 16, 2008 attached hereto. The bid opening is scheduled for May 21, 2008 with an engineer's opinion of estimated construction cost of \$1,437,000.

The total estimated value for both construction contracts is \$2,053,000.

The City has appointed you as our point of contact to provide direction for issues that arise during construction. We will also be working with Bob Morgenstern on a day to day basis and at weekly meetings. We will be responsible for providing contract administration, chairing the pre-construction conference and weekly meetings for both the pavement preparation and slurry sealing contracts, and providing observation and documentation of the work including, testing services, review of submittals and partial payment requests, and response to public inquiries.

SCOPE OF SERVICES

The scope of services has been determined from the above listed project requirements and our experience with similar projects.

CONSTRUCTION CONTRACT ADMINISTRATION:

1. Chair project meetings including pre-construction conference and weekly construction meetings, and prepare summary meeting notes.
2. Review Contractor's partial payment requests and make recommendation to the City.
3. Prepare contract change orders for City review and approval.
4. Review Contractor's schedule, monitor actual progress, notify City of identified delays, and work with Contractor to mitigate-scheduling issues.
5. Review and respond to Contractors Request for Information (RFI's)
6. Establish files and maintain records of the construction process including those described above and the following:
 - a. Daily observation reports.
 - b. Submittals.
 - c. Test results.
 - d. Photographs.
 - e. Potential claims submitted by Contractor.
 - f. Prepare a Final Report that includes all of the above.

CONSTRUCTION REVIEW AND OBSERVATION:

1. Perform construction observation and review to assess compliance with construction contract documents including traffic control, weather and temperature conditions, placement operations and coordination with adjacent property occupants. Time is based on 8 hour work days.
2. Notify the appropriate entity for the following activities:
 - a. Inspections and review by appropriate City departments.
 - b. Materials sampling and testing by the materials testing laboratory.
3. Prepare a final punch list in conjunction with the City staff and monitor the Contractor's progress toward completing the items.
4. The Construction Contractor is required to assume responsibility for job site conditions during the course of the construction of the project, including traffic control and safety of all persons and property on a continuous basis during the project duration.

5. Testing will be required for the Slurry Seal phase of work only and will be performed by Fugro West, Inc.

SERVICES TO BE PERFORMED BY OTHERS

We understand that the City will provide the following services:

1. All bid related tasks through issuance of Notice To Proceed.
2. Copies of plans and specifications as required.
3. Authorization and execution of contract change orders and partial payments with input from consultant.
4. Issuance of stop work notices to construction contractor, if required.
5. Observation, identification or determination of safety related items.
6. Attend final walk-through of project with client for acceptance of the work; file and send notices of completion.

COMPENSATION

We will complete the above-described scope of work on a TIME AND MATERIALS basis with an authorized limit based on our current Fee Schedule. Our fee has been developed based on a contract period of 40 working days for Pavement Preparation and 65 working days for Slurry Seal. We estimate the breakdown by consultant team member as follows:

Flowers & Associates, Inc.	\$	172,861
Fugro West, Inc.	\$	40,100
Cost of Subconsultants @ 10%	\$	<u>4,000</u>
Total:	\$	216,961

Our services will be billed for at approximately monthly intervals in accordance with our Fee Schedule in effect when our services are authorized. Our current fee schedule is attached. Payment is due upon receipt of statement and unpaid balances are subject to late charges.

Should unforeseen circumstances be encountered or additional or expanded work be required, we will notify you for authorization before proceeding with additional work.

SPECIFIC EXCLUSIONS

Specifically not included in the above Scope of Services/Compensation are the following:

1. Any involvement with hazardous waste, including detection, identification, evaluation, management and cleanup.
2. Supervision or management of construction work including traffic control, safety and control of any aspect of the contractors work.
3. Public hearings or agency reviews.

* * * * *

Should you have any questions regarding this proposal, please contact the undersigned. We appreciate your consideration of our firm and look forward to working with you on this project.

Sincerely,
FLOWERS & ASSOCIATES, INC.

By: 
Alan H. Chierici
Project Manager

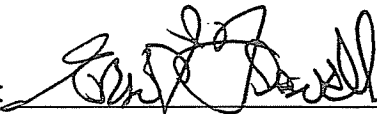
By: 
Eric L. Flavell, P.E.
Vice President

Encl.

FLOWERS & ASSOCIATES, INC

C I V I L E N G I N E E R S

PRINCIPALS:

Robert T. Flowers
RCE 16324
Stephen G. Flowers
RCE 26192
Vernon E. Williams
RCE 33660
Eric L. Flewell
RCE 33090

500 EAST MONTECITO STREET SANTA BARBARA, CA 93103

PHONE: 805.966.2224 • FAX: 805.965.3372

E-MAIL: www.flowersassoc.com



W.O. 0766C
5/20/08

**Estimated Staff Loading for:
City of Goleta 2008 / 2009 Pavement Rehabilitation Project
Pavement Preparation and Slurry Seal**

TASK	PRIN	ASSOC	SR ENG	SR INSP	W/P	TOTAL
Pavement Preparation Admin.						
Meetings (8)		6	16	8	7	37
Assist with partial payments (2)	2		2		2	6
Assist with change orders	1		3			4
Review schedules		2	6			8
Maintain records and files	2		16			18
Submittals		2	6			8
Respond to public and others	2		5			7
Slurry Seal Admin.						
A1. Meetings (12)		6	16	12	7	41
A2. Assist with partial payments (3)	3		3		2	8
A3. Assist with change orders	1		3			4
A4. Review schedules		2	6			8
A5. Maintain records and files	2		16			18
A6. Submittals		2	6			8
A7. Respond to public and others	2		5			7
Pavement Preparation Inspection						
Construction observation		6	24	400		430
Notify test/ insp.			4			4
Contract quantities	2		6			8
Punch list			6	6		12
Slurry Seal Inspection						
Construction observation		6	32	780		818
Notify test/ insp.			4			4
Contract quantities	2		6			8
Punch list			6	6		12
						0
Staff By Category Totals	15	36	197	1212	18	1478
Billing Rate (\$/hr)	\$167	\$149	\$134	\$112	\$75	
Total Personnel Cost (\$)	\$2,505	\$5,364	\$26,398	\$135,744	\$1,350	\$171,361
Staffing Ratio (% of total hrs)	1.0	2.4	13.3	82.0	1.2	
Average Personnel Cost (\$/hr)					115.94	
Description of Other Project Costs						VALUE (\$)
Repo, copy, fax						\$1,500
Fugro West						\$40,100
Cost of Sub-consultant						\$4,000
Total of other costs (\$)						\$45,600
Total Estimated Project Cost (\$)						\$216,961

Robert T. Flowers
RCE 18324
Stephen G. Flowers
RCE 26192
Vernon E. Williams
RCE 33690
Eric L. Flavell
RCE 33000

FLOWERS & ASSOCIATES, INC.
C I V I L E N G I N E E R S
201 NORTH CALLE CESAR CHAVEZ, SUITE 100, SANTA BARBARA, CA 93103
PHONE: 805.966.2224 • FAX: 805.965.3372
www.flowersassoc.com



City of Goleta Projects

FEE SCHEDULE

Effective January 1, 2008
Until Revised

ENGINEERING SERVICES

HOURLY RATE

	<u>1X</u>	<u>1 ½ X</u>	<u>2X</u>
Principal Engineer	\$167.00		
Associate Engineer	\$149.00		
Senior Engineer	\$134.00		
Resident Engineer	\$134.00		
Field Engineer*	\$116.00	\$137.00	\$156.00
Design Engineer	\$116.00		
Senior Inspector*	\$112.00	\$128.00	\$143.00
Staff Engineer	\$112.00		
Senior Technician	\$102.00		
Technician	\$ 97.00		
Project Administrator/Agency Coordinator	\$ 88.00		
Field Inspector	\$ 88.00		
Senior CAD Technician	\$ 88.00		
Word Processor	\$ 75.00		

EXPERT TESTIMONY

Expert Testimony, Deposition, Court Appearance and Research related thereto will be charged at 2.0 times the applicable hourly rate.

REIMBURSABLE EXPENSE

Routine office costs such as computer usage, telephone charges, office supplies, local travel, incidental postage, copying, faxes, etc. are included in the hourly rates. Plan copying, outside copying, plots, photographs, overnight mail, etc. will be reimbursed at cost.

CONSULTANTS

Subcontracts administered by Flowers & Associates, Inc. will be charged at cost plus 10%.

PREVAILING WAGE

*These services are provided at prevailing wage.



FUGRO WEST, INC.

211 E. Victoria Street, Suite D
Santa Barbara, California 93101
Tel: (805) 963-4450
Fax: (805) 564-1327

May 16, 2008
Project No. 2008.196

Flowers and Associates
201 N. Calle Cesar Chavez, Suite 100
Santa Barbara, California 93103

Attention: Mr. Alan Chierici

*Subject: Proposal for Sampling and Testing Services
Emulsion Aggregate Slurry
2008-09 Slurry Seal Project
Goleta, California*

Dear Mr. Chierici:

Fugro is pleased to present this proposal to Flowers and Associates for Sampling and Testing Services for the City of Goleta 2008-09 Slurry Seal project, in Goleta, California. The following proposal presents our proposed scope of services and our estimated fee for the project.

SCOPE OF SERVICES

On the basis of our understanding of the project, we have developed a scope of services consisting of project initiation, construction materials testing, and report preparation. Services associated with each of these tasks are summarized below.

Task 1 – Project Initiation. Under this task we will attend a pre-construction meeting with Flowers and Associates and the Contractor. During the pre-construction conference, we will expect that issues regarding slurry materials testing will be discussed.

Task 2 – Slurry Seal Testing. We propose to provide testing of the emulsified slurry seal materials used during construction. We propose to provide field sampling and laboratory testing of slurry seal specimens and materials. A Fugro senior field technician will perform field sampling and materials testing services on an on-call basis (24-hour notice).

Task 3 – Report Preparation. We proposed to provide wet track abrasion test results as they become available. Upon completion of the project we will prepare a brief letter-report summarizing the results of the slurry seal testing. The report will provide approximate locations of field tests, and a summary of results for the laboratory wet track abrasion testing performed.



ESTIMATED FEES

On the basis of our understanding of the project and our stated scope of services, we have estimated our fees associated with our proposed scope of services in accordance with our current Fee Schedule. A summary of our understanding of the project and the level of services requested is attached. We estimate that we can perform these services for an authorized limit fee of \$40,100.

CLOSURE

We appreciate the opportunity to submit this proposal and to continue our professional relationship with Flowers and Associates and the City of Goleta. If you have questions or require additional information, please contact the undersigned. We would be pleased to meet with you to discuss and review the proposed scope of services and associated level of effort.

Sincerely,
FUGRO WEST, INC.

A handwritten signature in black ink, appearing to read "Kenneth M. Clements".

Kenneth M. Clements, GE
Principal Engineer – Vice President

Copies: 2 – addressee

Attachment: Estimated Fee Worksheet



Project No. 2008.196

Flowers & Associates

City of Goleta 2008-09 Slurry Seal

Knowns:

- Sampling days include one day Test Strip
- Six (6) Extraction, Sieve, and Residue each day
- Six (6) WTAT Patties each day
- One (1) Complete Emulsion testing
- One (1) Complete Aggregate testing

Scope of Work:

Technician will collect bulk slurry seal samples and make two (2) patties per truck, three (3) trucks per day (6 patties per day total) Quick set slurry. About 1 hour set time required before patties are transported to laboratory
 Extraction, Sieve, and Residue (ESR) samples collected same time (6 total per day)

Estimated Fees:

Per Day	unit rate	hours per day	unit rate
Technician - Sampling	102	6	\$612
Patties	65	6	\$390
ESR	360	6	\$2,160
			<u>\$3,162</u>
Per Project Fees			
Sampling	\$3,162	12 days	\$37,944
Emulsified Asphalt Tests	\$920	1 per project	\$920
Aggregate Stockpile	\$190	2 per project	\$380
Project Management	\$800	1 per project	\$800
			<u>\$40,100</u>
Estimated Project Fees		12 Sampling days	\$40,100