



Agenda Item B.1
DISCUSSION/ACTION ITEM
Meeting Date: July 15, 2008

TO: Mayor and Councilmembers

FROM: Daniel Singer, City Manager

CONTACT: Vyto Adomaitis, RDA, Neighborhood Services & Public Safety Director

SUBJECT: Consideration of Joint Emergency Operations Center (EOC) with County of Santa Barbara

RECOMMENDATION:

Receive staff report and provide direction to staff as to whether to proceed with discussions with the County of Santa Barbara for the City's participation in a joint EOC with the County.

BACKGROUND:

Earlier this year, the City of Goleta was approached by the County of Santa Barbara Office of Emergency Services, with regard to a proposal for the City to participate in a joint EOC building project. Said project would be built on existing County owned property located off of Cathedral Oaks Road, adjacent to the Fire Department Headquarters Complex as seen in Attachments 1 and 2. City staff comprising the City Manager and the RDA, Neighborhood Services & Public Safety Director attended preliminary meetings to discuss design concepts and fiscal impacts with regard to requested financial participation and other project related discussions. This staff report is intended to provide the City Council with a report of those discussions and to gauge the level of interest the Council may have with regard to the City's participation.

DISCUSSION:

The County has set aside an estimated \$7 million dollars to construct a joint EOC facility on County owned land, outside of Goleta City limits. Preliminary estimates provided to the City reveal that the County would provide a 750 square foot facility within the proposed complex for the City to use in the event of a local emergency. Attachment 3 provides the most recent proposed floor plan. Associated initial costs approach \$750,000 for the proposed space. These costs represent construction to Critical Facility standards which include building design features to withstand earthquakes, floods, and other hazards.

On going costs to support the City's portion of the EOC complex have not been identified and it is unclear how the City's contribution would be reflected in the ownership of this public facility, located outside of City limits.

Design of the facility would accommodate general or multi-purpose uses during the year as well as back-up power, meeting rooms, communications, food, water, and other necessary capabilities to operate as an EOC during local emergencies. In addition to Goleta, the City of Santa Barbara has also been approached for participation in this proposed project and has indicated a strong interest in co-locating their EOC with the County facility. No other cities in the County of Santa Barbara are participating in this project. Attachment 4 outlines the County's Space Requirements Summary.

As we have seen with the recent GAP Fire, it is clear that coordination and communication among the various agencies during emergency incidents are critical components of any effective emergency management program. Having a facility that brings all of the affected agencies under one roof is a positive goal. As a contract City, Goleta currently does not have a fully equipped EOC facility within City Hall, as the City is in leased space. Participation in the County's EOC project could provide Goleta with enhanced emergency management capabilities. Recent experience reveals that Goleta residents desire a local point of contact for communication and interaction with City Hall.

In conclusion, staff supports the concept of a joint EOC project. However, without further clarity as to the initial and on-going costs and the overall consideration of the City's fiscal condition and ability to support a significant cost for a facility that would be of limited use, staff is hesitant to recommend approval for this project to the City Council. Furthermore, some consideration should be given to the fact that the City has been in discussions about owning our own City Hall which could work to serve our own EOC needs.

ALTERNATIVES:

1. The City Council could choose not to participate in this project.
2. The City Council could choose to participate in this project, directing staff to obtain the necessary information related to fiscal impacts and return to the City Council for formal consideration and budget related actions.

FISCAL IMPACTS:

Preliminary estimates for Goleta's portion of the joint EOC approach \$750,000. This cost does not include on going costs which have not been identified at this time.

Submitted By:

Approved By:

Vyto Adomaitis
RDA, NS & Public Safety
Director

Daniel Singer
City Manager

ATTACHMENTS:

1. Joint EOC Proposed Site Plan (Aerial)
2. Joint EOC Proposed Site Plan (Sketch)
3. Joint EOC Proposed Floor Plan
4. Joint EOC Space Requirements Summary

Proposed Site Plan (Aerial)
Joint Emergency Operations Center
Attachment 1



Site Plan (Aerial)

Proposed Site Plan (Sketch)
Joint Emergency Operations Center
Attachment 2

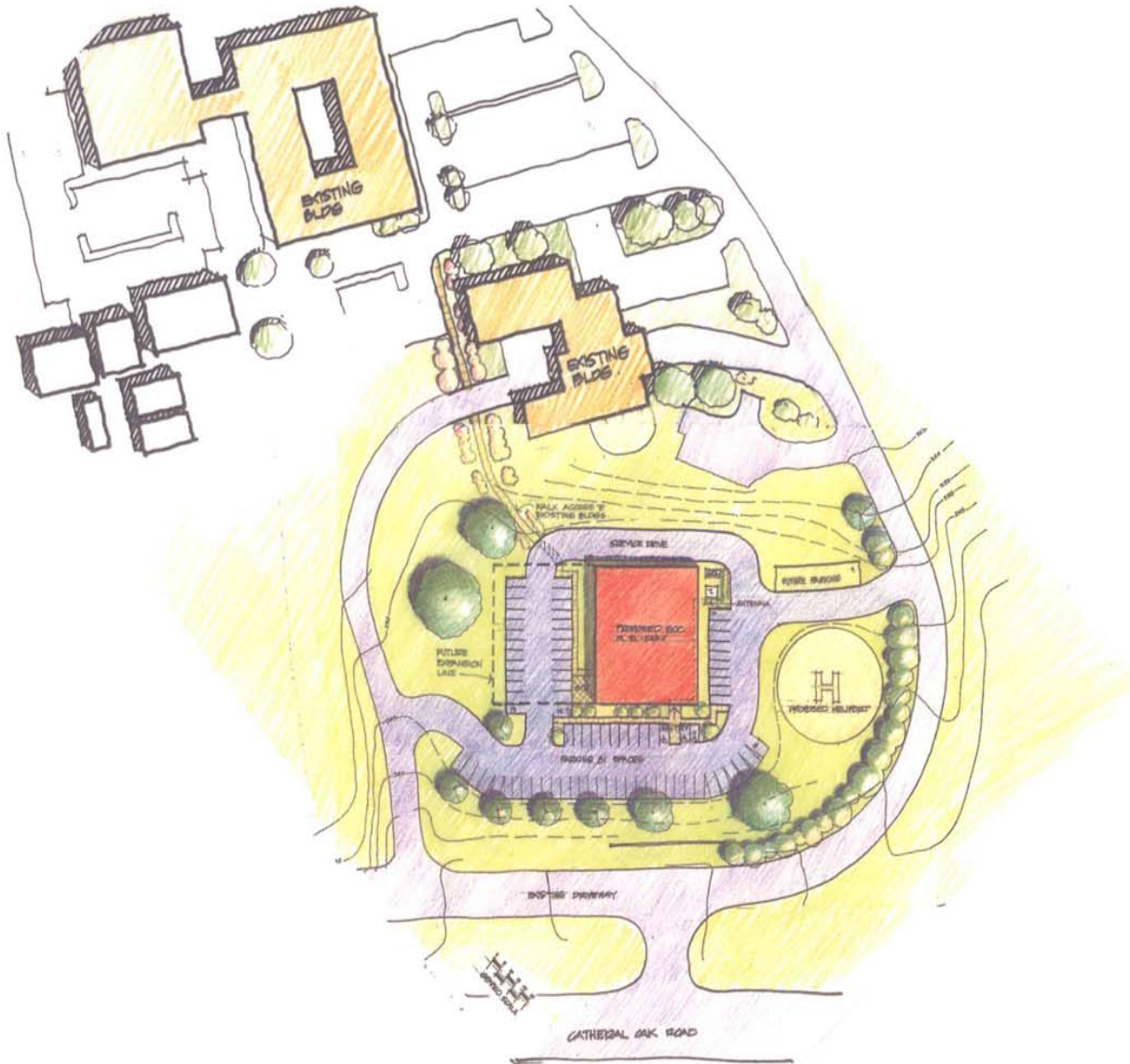

EMERGENCY OPERATIONS CENTER

SCHMATIC DESIGN
 SANTA BARBARA, CALIFORNIA

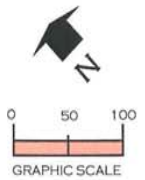

SITE PLAN
 SCHEME A
 JUNE 4, 2008



THE AUSTIN COMPANY
 Copyright THE AUSTIN COMPANY 2008



County of Santa Barbara

Proposed Floor Plan
Joint Emergency Operations Center
Attachment 3

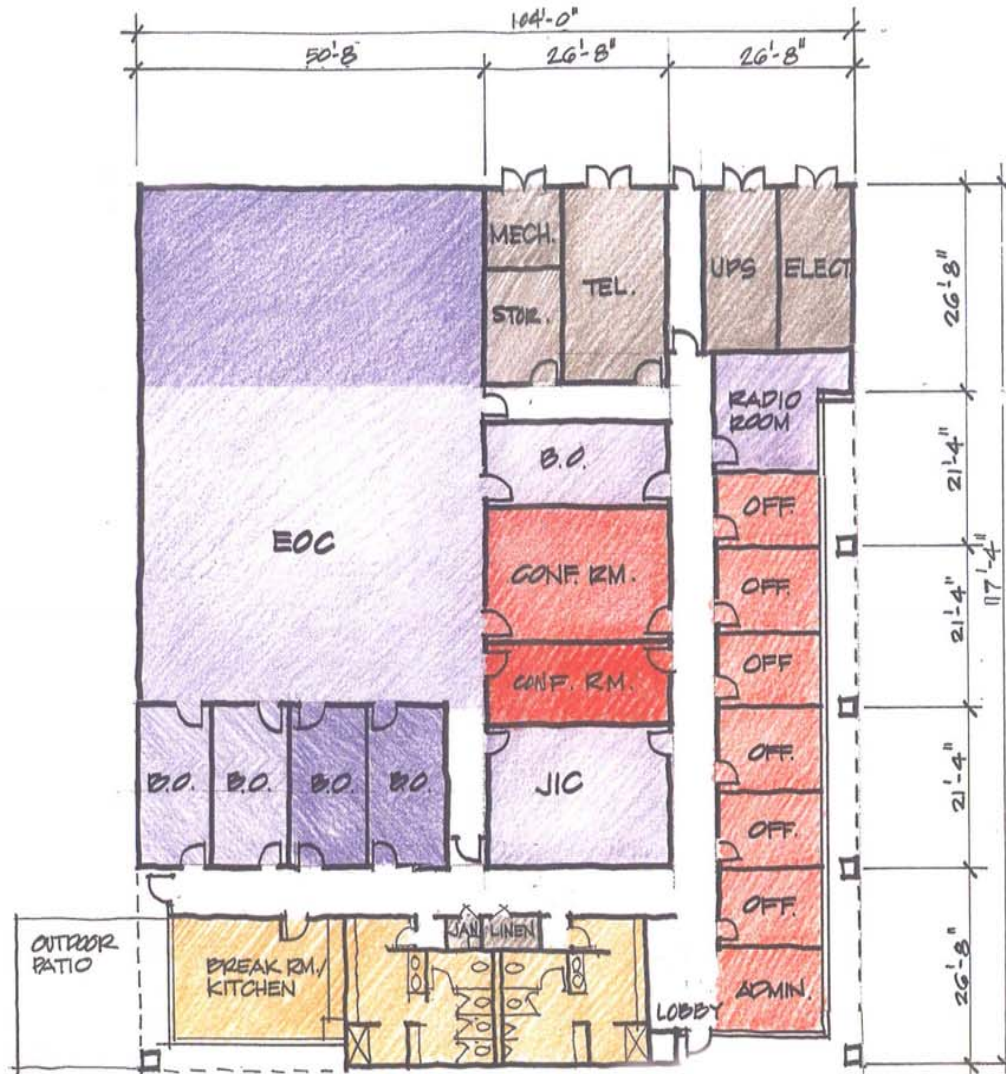

12,600 GSF

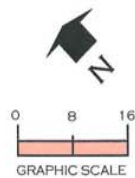
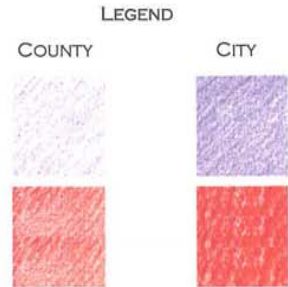

FLOOR PLAN WITH CITY
 SCHEME A

JUNE 4, 2008



THE AUSTIN COMPANY
 Copyright THE AUSTIN COMPANY 2008



EMERGENCY OPERATIONS CENTER

SCHEMATIC DESIGN
 SANTA BARBARA, CALIFORNIA

Space Requirements Summary
Joint Emergency Operations Center
Attachment 4



COUNTY OF SANTA BARBARA EOC

SPACE REQUIREMENTS SUMMARY
Including the City of Santa Barbara's Requirements

Space Description	Staff	Original Sq. Ft.	Reduced Sq. Ft.	Qty.	Original Total	Reduced Total	City Reqrmts.	Total	Remarks
EOC	24	2,200		1	2,200	2,000	1,500	3,500	18 - 20 Additional City Staff
General Storage	0	100		1	100	100	50	150	
Management Conference Room	16	800	500	1	800	500	300	800	Additional Mgmt Conf Rm for City
Joint Information Center (JIC)	12	500		1	500	500		500	
Break-Out Rooms	0	250		3	750	750	500	1,250	2 Additional Break-Out Rms for City
Radio (ARES) Room	2	250		1	250	250		250	
Training / Bunk Room	0	500	0	1	500	0		0	Assume use of break-out rm
Cot & Linen Storage	0	100		1	100	100		100	
Offices	6	150		6	900	900		900	Personnel in EOC during Activation
Administration	1	150		1	150	150		150	
Lobby	0	150		1	150	150		150	
Media Room	0	600	0	1	600	0		0	Assume media will use other County facilities
Rear Projection Room	0	250	0	1	250	0		0	Assume front projection
Break Room / Kitchen	0	500	225	1	500	225	225	450	
Toilet Rooms / Shower	0	350		2	700	700		700	
Telecom	0	400		1	400	400		400	
Electrical Room	0	250		1	250	250		250	
Battery/UPS Room	0	250		1	250	250		250	
Emergency Generator	0	500	0	1	500	0		0	Assume gen set outside
Mechanical / Maintenance	0	100	0	1	100	100		100	
Circulation (15%)					1,632	1,106	386	1,485	
TOTAL STAFF	61								
					Sub-Total	11,582	8,424	2,961	11,385
					Building Support/Circulation	1,160	850	1,140	10% building grossing factor
					Bldg. Gross Sq. Ft.	12,740	9,270	12,530	